

II. FISCAL IMPACT ANALYSIS

A. Five Year Summary of Fiscal Impact:

Fiscal Years	2006	2007	2008	2009	2010
Capital Expenditures	(\$ 228.62)	-0-	-0-	-0-	-0-
Operating Costs	-0-	-0-	-0-	-0-	-0-
External Revenues	-0-	-0-	-0-	-0-	-0-
Program Income (County)	-0-	-0-	-0-	-0-	-0-
In-Kind Match (County)	-0-	-0-	-0-	-0-	-0-
NET FISCAL IMPACT	(\$ 228.62)	-0-	-0-	-0-	-0-
# ADDITIONAL FTE POSITIONS (Cumulative)					

Is Item Included in Current Budget? Yes No

Budget Acct No.: Fund 3511 Agency 365 Org. S190 Object 8101

Reporting Category _____

B. Recommended Sources of Funds/Summary of Fiscal Impact:

C. Departmental Fiscal Review: R.A. Ward 2/1/06

III. REVIEW COMMENTS

A. OFMB Fiscal and/or Contract Dev. and Control Comments:

Actual project cost is less than estimated resulting in a decrease in assessment to property owners of \$114.31 (50% of total project cost)

Jim Dink 6-27-06
OFMB
ack 6-27-06
LW
6/28/06

Jim J. Jueart 6/28/06
Contract Dev. and Control
EJone-6/28/06

B. Legal Sufficiency:

Marlene R. Otto 06/30/06
Assistant County Attorney

C. Other Department Review:

Department Director

This summary is not to be used as a basis for payment.

Background and Justification: (Continued)

89th Place North is in an unincorporated area of Palm Beach County (County) located within the service area of the Indian Trail Improvement District (District). On January 10, 2006, the County and the District entered into a Funding Agreement (R-2006-0051) providing for construction of the Project.

On January 10, 2006, the County held a Public Hearing (R-2006-0113), and adopted an assessment roll for the project. The original estimated total cost, based on fifty percent (50%) of the cost payable over ten (10) years at 6.5%, was \$1,471.30 per acre. The actual project cost was less than estimated, resulting in a reduction in the assessments to the property owners as follows:

	<u>Project Total</u>	<u>Assessable Portion 50% of Total</u>	<u>Cost Per Acre</u>
Estimated Costs	\$42,403.00	\$21,201.50	\$1,471.30
Final Cost	\$42,174.38	\$21,087.19	\$1,463.37
Savings	\$ 228.62	\$ 114.31	\$ 7.93

This office recommends the adoption and approval of the above named actions in order to continue with the Assessment Process for this project.

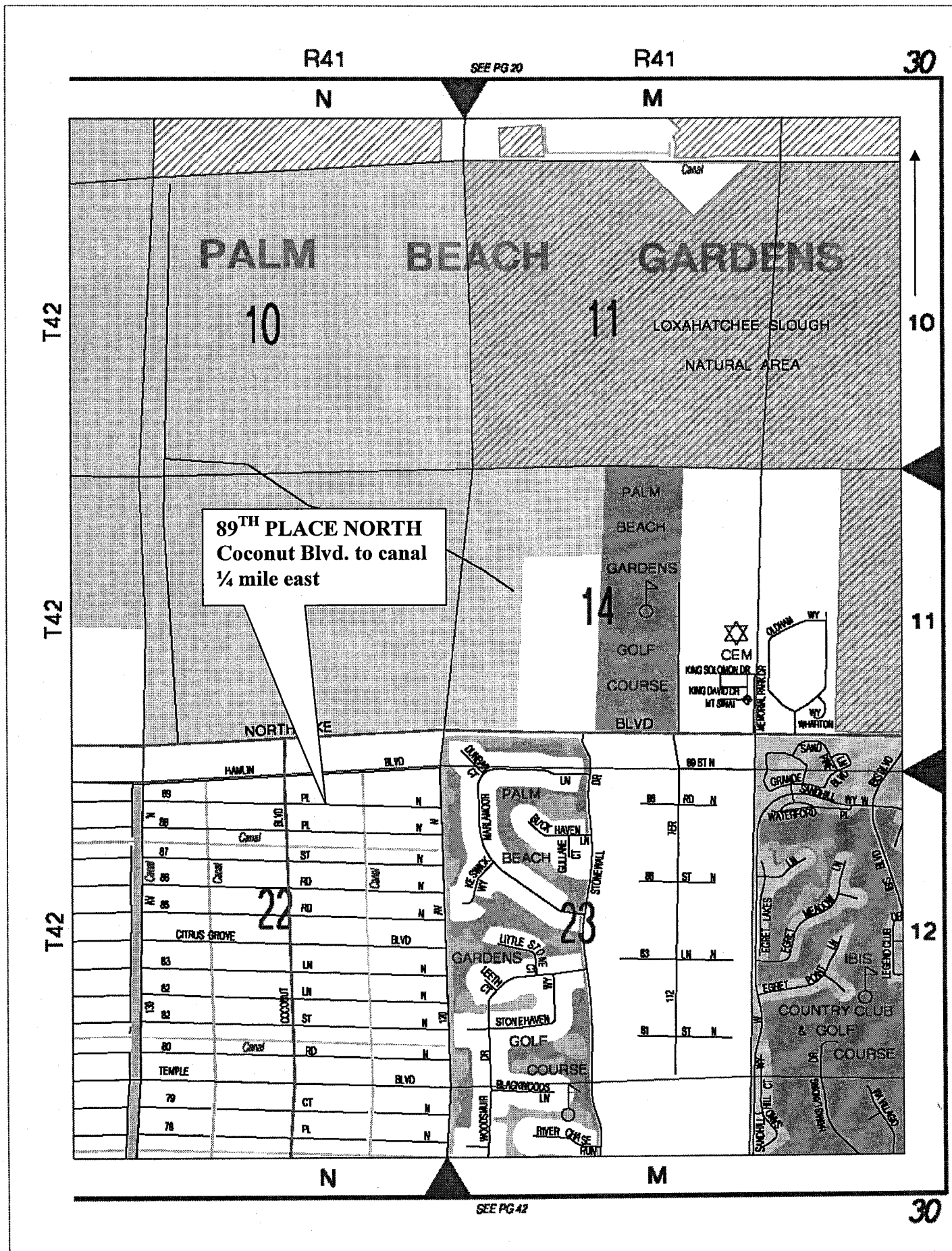

LOCATION MAP - ATTACHMENT 1

RESOLUTION NO. R-2006-

RESOLUTION OF THE BOARD OF COUNTY COMMISSIONERS OF PALM BEACH COUNTY, FLORIDA AMENDING THE SPECIAL ASSESSMENT FOR 89TH PLACE NORTH FROM COCONUT BOULEVARD TO A CANAL ONE QUARTER MILE EAST, SECTION 22, TOWNSHIP 42 SOUTH, RANGE 41 EAST, STREET IMPROVEMENT PROJECT, PURSUANT TO A PUBLIC HEARING HELD THEREON.

WHEREAS, a confirming special assessment process was approved by the Board of County Commissioners (Board) on January 10, 2006 (R-2006-0113) for the 89th Place North Street Improvement Project, authorized pursuant to Palm Beach County Ordinance No. 94-11, as amended by Ordinance No. 95-53 known as the Municipal Service Taxing Unit Road Improvement Ordinance. Due to a decrease in final project costs, it is necessary to amend the final project costs from \$42,403.00 to \$42,174.38 resulting in a reduction of \$228.62; and

WHEREAS, fifty percent (50%) of the cost of the street improvements, will be repaid by special assessment upon specially benefited parcels of land; and

WHEREAS, the method of assessment is to be on a per acre basis for the street improvements; and

WHEREAS, pursuant to Section 18 of Ordinance No. 94-11, as amended by Ordinance No. 95-53, the Board of County Commissioners did hold a public hearing on the 10th day of January 2006, at the Commission Chambers of the Board of County Commissioners of Palm Beach County, Florida, so as to satisfy the requirements of Ordinance 94-11 as amended by Ordinance No. 95-53; and

WHEREAS, the Board of County Commissioners finds that the public notice and public hearing requirements of Ordinance No. 94-11 as amended by Ordinance No. 95-53 have been substantially met.

NOW, THEREFORE, BE IT RESOLVED BY THE BOARD OF COUNTY COMMISSIONERS OF PALM BEACH COUNTY, FLORIDA, THAT:

1. The Special Assessment Roll for the improvement project for 89th Place North, Section 22, Township 42 South, Range 41 East, as on file in the Clerk of this Board and attached hereto as EXHIBIT II is hereby approved and confirmed and shall be recorded by the Clerk of the Board of County Commissioners in a special book to be known as "The Improvement Lien Book" and

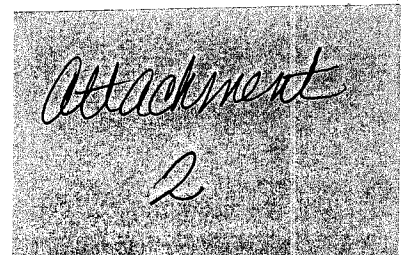

RESOLUTION NO. R-2006-
July 11, 2006

the record of the lien in said book shall constitute prima facie evidence of the validity of said lien.

2. Pursuant to Ordinance No. 94-11 as amended by Ordinance No. 95-53, the following project is hereby approved: 89th Place North Street Improvement Project in Section 22, Township 42 South, Range 41 East, Palm Beach County, Florida.

3. The said special assessments are hereby made upon all parcels of land described in said amended Special Assessment Roll in the amount shown thereon.

4. Pursuant to Ordinance No. 94-11 as amended by Ordinance No. 95-53, any and all special assessments made pursuant to this Amending Resolution, which have not been paid in full within thirty (30) days after completion of the subject improvements for which said assessment was made, shall be subject to interest at a rate of six and one-half ($6\frac{1}{2}\%$) percent per annum from the date of the acceptance of said improvement by Palm Beach County and shall be payable in ten (10) equal annual installments.

5. The amended project costs of the street improvements are reflected on EXHIBIT I (Report of Cost). The original total cost of the street improvements was \$42,403.00. This Resolution decreases the total project costs by \$228.62, resulting in a total project cost of \$42,174.38. Fifty percent (50%) of the total costs will be paid by special assessment.

6. Pursuant to Section 21 of Ordinance No. 94-11 as amended by Ordinance No. 95-53, if any special assessment made under this resolution shall be either in whole or part vacated or set aside by the judgment of any court, or the Board of County Commissioners shall be satisfied that any such assessment is so defective that the same cannot be enforced or collected, or if the Board will have omitted to make any such assessment when it might have done so, the Board of County Commissioners will take all necessary steps to cause a new assessment to be made for any improvement against any property specially benefited by such improvement.

7. The Board of County Commissioners further finds that each parcel listed on EXHIBIT II will obtain a special benefit which is at least equal to the amount of special assessment made against each such parcel.

RESOLUTION NO. R-2006-
July 11, 2006

The foregoing Resolution was offered by Commissioner _____ who moved
its adoption. The motion was seconded by Commissioner _____, and upon being put to a
vote, the vote was as follows:

TONY MASILOTTI, CHAIRMAN

ADDIE L. GREENE, VICE CHAIRPERSON

KAREN T. MARCUS

JEFF KOONS

WARREN H. NEWELL

MARY MCCARTY

BURT AARONSON

The Chairman thereupon declared the Resolution duly passed and adopted this day of
_____, 2006.

PALM BEACH COUNTY, FLORIDA, BY ITS
BOARD OF COUNTY COMMISSIONERS

By: _____
Tony Masilotti, Chairman

SHARON R. BOCK
CLERK & COMPTROLLER

By: _____
Deputy Clerk

APPROVED AS TO FORM AND
LEGAL SUFFICIENCY:

By:  6/30/06
County Attorney

PROJECT NO. 2006154

REPORT OF COST

89th PLACE NORTH - COCONUT BLVD TO CANAL
PAVING & DRAINAGE IMPROVEMENTS

LEGAL ADVERTISING	\$	<u>0.00</u>
CONSTRUCTION COSTS	\$	<u>42,174.38</u>
ENGINEERING & SURVEY COSTS	\$	<u>0.00</u>
SUB-TOTAL	\$	<u>42,174.38</u>
ADMINISTRATIVE COSTS, FEES, CONSTRUCTION COORDINATION AND CONTINGENCIES	\$	<u>0.00</u>
TOTAL	\$	<u>42,174.38</u>
<u>SUPPLEMENTAL FUNDING</u>		
TOTAL MSTU FUNDING	\$	<u>42,174.38</u>
ASSESSABLE COST (50%)	\$	<u>21,087.19</u>
ABUTTING ACREAGE - - -		<u>14.41</u>
ASSESSMENT PER ACRE	\$	<u>1,463.37</u>



Assessment Roll - Final

89TH PLACE NORTH
COCONUT BLVD. TO CANAL 1/4 MILE EAST
PAVING IMPROVEMENT PROJECT
PROJECT NO. 2006154

FUND AGENCY ORG	COMMISSION DISTRICT	SECTION	TOWNSHIP	RANGE
	6 TONY MASILOTTI	22	42S	41E

No.	Homeowner/Mailing Address	PCN/Legal Description	Assessable Acreage	Total Assessment	Annual Cost/Per Year	Notes
1	AUBIN DELOUIS 8932 COCONUTBLV WEST PALM BEACH, FL 33412-2677	00-41-42-22-00-000-113.0 22-42-41, N 239 FT OF S 5169 FT OF W 249 FT OF E 2648 FT OF SEC A/K/A Y-244	1.37	\$2,004.82	\$278.88	
2	COLLYMORE GLADSTONE & 12441 89TH PL N WEST PALM BEACH, FL 33412-2386	00-41-42-22-00-000-114.0 22-42-41, N 239 FT OF S 5169 FT OF W 209 FT OF E 2399 FT OF SEC A/K/A Y-241	1.15	\$1,682.88	\$234.10	
3	SPATARA ANTHONY & ** Confidential Record **	00-41-42-22-00-000-115.0 22-42-41, N 239 FT OF S 5169 FT OF W 209 FT OF E 2190 FT OF SEC A/K/A Y-200	1.15	\$1,682.88	\$234.10	
4	WATSON RICK & 12365 89TH PL N WEST PALM BEACH, FL 33412-2386	00-41-42-22-00-000-116.0 22-42-41, N 239 FT OF S 5169 FT OF W 209 FT OF E 1981 FT OF SEC IN OR2475P218	1.15	\$1,682.88	\$234.10	
5	ADAMS JOHN R 12325 89TH PL N WEST PALM BEACH, FL 33412-2386	00-41-42-22-00-000-117.0 22-42-41, N 239 FT OF S 5169 FT OF W 209 FT OF E 1772 FT OF SEC IN OR2427P1553	1.15	\$1,682.88	\$234.10	

Assessments which have not been paid in full within thirty days after completion of the subject improvements for which said assessment was made, will be charged interest at a rate of six and a half (6.5) percent per annum from the date of the acceptance of said improvement by Palm Beach County and shall be payable in ten equal annual installments of principal and interest.



Assessment Roll - Final

89TH PLACE NORTH
COCONUT BLVD. TO CANAL 1/4 MILE EAST
PAVING IMPROVEMENT PROJECT
PROJECT NO. 2006154

FUND	AGENCY	ORG	COMMISSION DISTRICT		SECTION	TOWNSHIP	RANGE
			6 TONY MASILOTTI		22	42S	41E

No.	Homeowner/Mailing Address	PCN/Legal Description	Assessable Acreage	Total Assessment	Annual Cost/Per Year	Notes
6	PARROTT MARK & 12289 89TH PL N WEST PALM BEACH, FL 33412-2374	00-41-42-22-00-000-118.0 22-42-41, N 239 FT OF S 5169 FT OF W 239 FT OF E 1563 FT OF SEC A/K/A Y-153	1.31	\$1,917.01	\$266.67	
7	SCHMIDT DENNIS S & 12288 89TH PL N WEST PALM BEACH, FL 33412-2373	00-41-42-22-00-000-131.0 22-42-41, N 239 FT OF S 4930 FT OF W 239 FT OF E 1563 FT OF SEC A/K/A Y-152	1.31	\$1,917.01	\$266.67	
8	ODIAS BOLAND & 12326 89TH PL N WEST PALM BEACH, FL 33412-2385	00-41-42-22-00-000-132.0 22-42-41, N 239 FT OF S 4930 FT OF W 209 FT OF E 1772 FT OF SEC A/K/A Y-157	1.15	\$1,682.88	\$234.10	
9	GRAY BEVERLY 12364 89TH PL N WEST PALM BEACH, FL 33412-2385	00-41-42-22-00-000-133.0 22-42-41, N 239 FT OF S 4930 FT OF W 209 FT OF E 1981 FT OF SEC A/K/A Y-196	1.00	\$1,463.37	\$203.56	
10	KISTLER LILLIAN R 12400 89TH PL N WEST PALM BEACH, FL 33412-2385	00-41-42-22-00-000-134.0 22-42-41, N 239 FT OF S 4930 FT OF W 209 FT OF E 2190 FT OF SEC A/K/A Y-201	1.15	\$1,682.88	\$234.10	

Assessments which have not been paid in full within thirty days after completion of the subject improvements for which said assessment was made, will be charged interest at a rate of six and a half (6.5) percent per annum from the date of the acceptance of said improvement by Palm Beach County and shall be payable in ten equal annual installments of principal and interest.



Assessment Roll - Final

89TH PLACE NORTH
COCONUT BLVD. TO CANAL 1/4 MILE EAST
PAVING IMPROVEMENT PROJECT
PROJECT NO. 2006154

FUND AGENCY ORG	COMMISSION DISTRICT	SECTION TOWNSHIP RANGE
	6 TONY MASILOTTI	22 42S 41E

No.	Homeowner/Mailing Address	PCN/Legal Description	Assessable Acreage	Total Assessment	Annual Cost/Per Year	Notes
11	VU TRONG 12442 89TH PL N WEST PALM BEACH, FL 33412-2385	00-41-42-22-00-000-135.0 22-42-41, N 239 FT OF S 4930 FT OF W 209 FT OF E 2399 FT OF SEC A/K/A Y-240	1.15	\$1,682.88	\$234.10	
12	NGUYEN BAY & 12472 89TH PL N WEST PALM BEACH, FL 33412-2385	00-41-42-22-00-000-136.0 22-42-41, N 239 FT OF S 4930 FT OF W 249 FT OF E 2648 FT OF SEC A/K/A Y-245	1.37	\$2,004.82	\$278.88	
Totals:			14.41	\$21,087.19		

Note	Description/Totals	
1	ASSIGNED FRONT FOOTAGE	0
2	ASSIGNED AVERAGE FRONT FOOTAGE	0
3	50% OF SUM OF ALL ABUTTING FOOTAGE	0

Assessments which have not been paid in full within thirty days after completion of the subject improvements for which said assessment was made, will be charged interest at a rate of six and a half (6.5) percent per annum from the date of the acceptance of said improvement by Palm Beach County and shall be payable in ten equal annual installments of principal and interest.