

I. FISCAL IMPACT ANALYSIS

A. Five Year Summary of Fiscal Impact:

Fiscal Years	2006	2007	2008	2009	2010
Capital Expenditures	\$10,500,000	-0-	-0-	-0-	-0-
Operating Costs	-0-	-0-	-0-	-0-	-0-
External Revenues	-0-	-0-	-0-	-0-	-0-
Program Income (County)	-0-	-0-	-0-	-0-	-0-
In-Kind Match (County)	-0-	-0-	-0-	-0-	-0-
NET FISCAL IMPACT	\$10,500,000	-0-	-0-	-0-	-0-
# ADDITIONAL FTE POSITIONS (Cumulative)					

Is Item Included in Current Budget? Yes X No

Library Account
Budget Account No:

Fund 3022 Dept. 321 Unit L057 Object 6502 Amount \$10,500,000
Reporting Category

B. Recommended Sources of Funds/Summary of Fiscal Impact:

Funds are being transferred from GO Bond Reserves into the established project unit. This transfer will leave a balance of \$11.8 million in reserves.

C. Departmental Fiscal Review: Lavinia D. Gardner
Lavinia D. Gardner, Chief Financial Officer

III. REVIEW COMMENTS:

A. OFMB Budget and/or Contract Development & Control Comments:

Jim Dink 7/6/06
OFMB/Budget

Jim J. Jacobson 7/6/06
Contract Development and Control
6.8.2006-7/6/06

B. Legal Sufficiency:

James C. [Signature] 7/6/06
Assistant County Attorney

This amendment complies with our review requirements.

C. Other Department Review:

John J. Callahan III
John J. Callahan III, Library Director

This summary is not to be use as a basis payment.

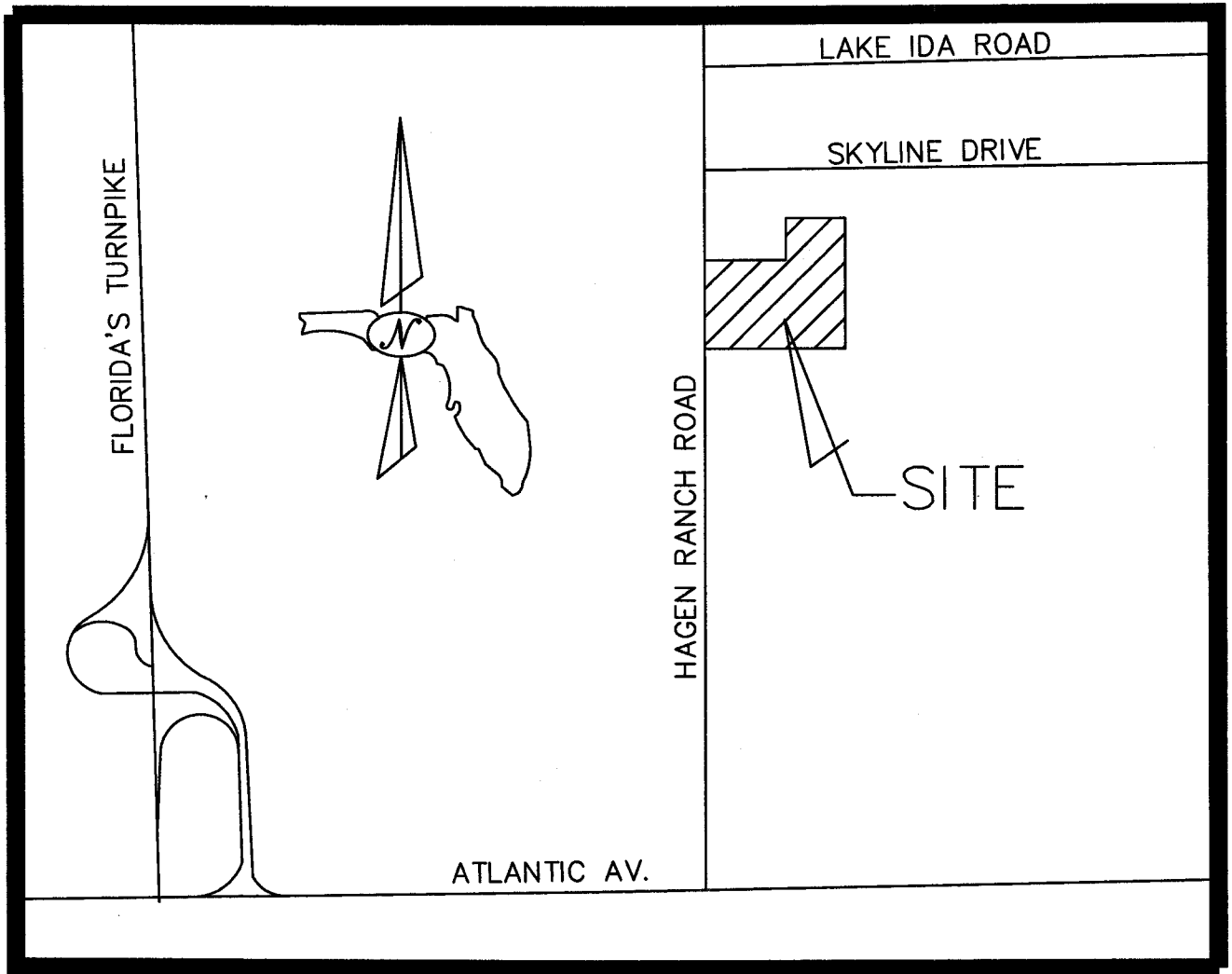

LOCATION MAP

N.T.S.

ATTACHMENT # 1



Inter-Office Memorandum

Palm Beach County Library

To: Cynthia Collins

From: Alicia Garrow *A. Garrow*

Date: June 22, 2006

Subject: Budget Transfer

Please approve the following budget transfer to establish the budget for the Hagan Ranch Road capital project which has been previously approved by the BCC:

3022-321-L057-6502	10,500,000
3022-321-9900-9908	(10,500,000)

Document BGEX-321-062206-1722 reflecting this transfer is on hold in Advantage for your approval.

Thank you for your help. If you have any questions or need any additional information, please contact me at garrowa@pbclibrary.org or extension 42704.

Approved by: *Louisa D. Gardner*

G:\FINANCE\FY06Bud Amd & Trans\budget transfer for Hagan Ranch Road Construction.wpd

ATTACHMENT # 2

**AMENDMENT # 8 TO CONTRACT FOR
CONSTRUCTION MANAGEMENT SERVICES
HAGEN RANCH ROAD BRANCH LIBRARY
PROJECT NO. 03213**

WHEREAS, the Owner and Construction Manager, The Weitz Company, acknowledge and agree that the Contract between Owner and Construction Manager dated September 23, 2003 (R2003-1542) is in full force and effect and that this Amendment merely supplements said Contract;

WHEREAS, the parties hereto entered into a Contract between Owner and Construction Manager whereby the Construction Manager has rendered or will render construction services as specified therein; and

WHEREAS, the parties have negotiated a Guaranteed Maximum Price, including Construction Managers fees for construction and warranty services and other issues as set forth herein and in the Contract;

NOW THEREFORE, in exchange for the mutual covenants and promises set forth herein and the sums of money agreed to be paid by the Owner to the Construction Manager, the parties agree as follows:

(1) GUARANTEED MAXIMUM PRICE

Pursuant to Article 2.2 and Article 6 of the Contract between Owner and Construction Manager, the parties have agreed to the establishment of a Guaranteed Maximum Price of **\$10,150,101** for the construction cost of the new building, parking lot, and site work for the Hagen Ranch Road Branch Library. Refer to Exhibit A. The GMP is based on the following: drawings and specifications dated March 23, 2006

(2) SCHEDULE OF TIME FOR COMPLETION

Pursuant to Article 5.3, Construction Manager shall substantially complete the project within **Three Hundred Sixty Five (365)** calendar days of receiving the Notice to Proceed.

(3) ATTACHMENTS: Exhibit A - GMP Proposal
Public Construction Bond
Form of Guarantee
Insurance Certificate(s)

ATTACHMENT #3

IN WITNESS WHEREOF, the Board of County Commissioners of Palm Beach County, Florida has made and executed this Amendment on behalf of the COUNTY and CONSTRUCTION MANAGER has hereunto set its hand the day and year above written.

ATTEST:
SHARON R. BOCK, CLERK &
COMPTROLLER

PALM BEACH COUNTY BOARD, FLORIDA
Political Subdivision of the State of Florida
BOARD OF COUNTY COMMISSIONERS

By: _____
Deputy Clerk

By: _____
Tony Masilotti, Chairman

APPROVED AS TO FORM
AND LEGAL SUFFICIENCY

APPROVED AS TO TERMS
AND CONDITIONS

By: _____
County Attorney

By: Ann Mary Wolf
Director - FD&O

WITNESS: FOR CONSTRUCTION MANAGER
SIGNATURE

CONSTRUCTION MANAGER:

THE WEITZ COMPANY

Signature

Dennis Gallagher 6-20-06
Signature

Jon Tori
Name (type or print)

Dennis Gallagher
Name (type or print)

President.
Title

(Corporate Seal)

16 June 2006

Mr. William Debeck, Project Manager
Palm Beach County Board of County Commissioners
Facilities Development & Operations - Capital Improvements Division
3323 Belvedere Road, Building #1169
West Palm Beach, Florida 33406

Re: 95% Construction Document – GMP Proposal (Revision #1a)
West Atlantic (Hagen Ranch) Branch Library – Delray Beach, Florida
Phase #2 - Site Development & Library
Project No. 03213

Dear Mr. Debeck:

As requested during our 5/31/06 GMP proposal review meeting, The Weitz Company presents our modified “95% Construction Document - GMP Proposal” for your approval. The proposal was prepared using the PGAL documents dated March 23, 2006 and received April 4, 2006.

The total project cost is Ten Million One Hundred Fifty Thousand One Hundred One Dollars (\$10,150,101). Escalation and contingency are estimates only and GMP will not become fixed until final 100% CD release.

The Weitz Company thanks Palm Beach County Capital Improvements Division for this opportunity.

Sincerely,
The Weitz Company

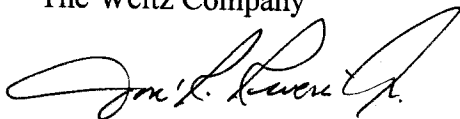

José R. Rivera, Jr.
Preconstruction Manager



**BUILD IN
GOOD COMPANY.**

Estimate Summary

Project Name: **PBC West Atlantic Branch Library**
 Job Number: **PBC #03212; TWC #F103300**
 Estimate Date: **22MAY2006 Rev 1a**

Gross Area (GSF): **34,586 GSF**
 Estimate Status: **95% GMP**
 Addenda: **N/A**

Line No.	Bid Ticket	Trade Description	95% CD/GMP (5/22/06 Rev 1a)	50% CD (12/19/05)	Variance	Variance			SBE	Comments
						Market Adjustment	Scope Adjustments	Estimate Adjustments		
1	01A	Construction Manager's Fee	\$ 702,002	\$ 333,488	\$ 368,514	\$ 18,514		\$ 350,000		* Shifting of Activity Items from 01C * Current Market Affect * Additional Staffing (from Experience)
2	01B	Testing/QC/Misc	\$ -	\$ 38,571	\$ (38,571)			\$ (38,571)		* Deleted Testing (By Owner)
3	01C	General Conditions	\$ 78,351	\$ 288,276	\$ (209,925)			\$ (209,925)		* Shifting of Activity Items to 01C
4	03A	Complete Concrete Pckg	\$ 1,322,967	\$ 1,399,734	\$ (76,767)	\$ (76,767)			\$ 97,141	* Final Dwg Det resulted in Firmer Pricing * Competition amongst Subcontractors
5	04A	Masonry	\$ -	\$ 15,749	\$ (15,749)		\$ (15,749)			* Deletion of Masonry Dumpster Walls
6	05A	Structural Steel	\$ 508,036	\$ 456,451	\$ 51,585		\$ 51,585			* Additional Steel Columns for Canopies
7	05C	Misc Metals	\$ 20,307	\$ 29,826	\$ (9,519)	\$ (9,519)				* Current Market Affect
8	06A	Rough Carpentry	\$ 74,850	\$ 38,908	\$ 35,942			\$ 35,942		* Addition of Carpenter Helper
9	06E	Millwork	\$ 131,650	\$ 83,775	\$ 47,875	\$ 47,875				* Current Market Affect
10	07A	Insulation	\$ 37,278	\$ 61,992	\$ (24,714)	\$ (24,714)				* Final Dwg Det resulted in Firmer Pricing
11	07E	Membrane Roofing	\$ 516,965	\$ 420,727	\$ 96,238		\$ 96,238			* Change in Roofing Specification Used the Specified Roofing
12	07I	Caulking & Waterproofing	\$ 52,605	\$ 48,105	\$ 4,500	\$ 4,500				* Current Market Affect * Use of an 'All Inclusive' Subcontractor
13	08A	Doors, Frames & Hrdwr	\$ 76,613	\$ 67,960	\$ 8,653	\$ 8,653				* Current Market Affect
14	08I	Storefronts & Glazing	\$ 251,575	\$ 231,951	\$ 19,624	\$ 19,624			\$ 226,235	* Current Market Affect
15	09C	Drywall	\$ 472,459	\$ 575,785	\$ (103,326)			\$ (103,326)	\$ 419,129	* Current Market Affect
16	09D	Tilework	\$ 95,445	\$ 89,438	\$ 6,007		\$ 6,007			* Additional Tile at Drinking Fountains
17	09E	Acoustical Treatment	\$ 70,992	\$ 189,243	\$ (118,251)	\$ (103,251)	\$ (15,000)			* Final Dwg Det resulted in Firmer Pricing * Reduction of amount of Wall Panels
18	09G	Carpet & Resilient Flooring	\$ 168,521	\$ 144,533	\$ 23,988	\$ 8,988	\$ 15,000		\$ 151,868	* Added Multi-Patterned Carpet * Current Market Affect
19	09K	Painting	\$ 79,920	\$ 72,752	\$ 7,168	\$ 7,168			\$ 78,739	* Current Market Affect
20	10A	General Specialties	\$ 15,603	\$ 48,080	\$ (32,477)	\$ (32,477)				* Current Market Affect
21	10D	Signage	\$ 39,763	\$ 24,868	\$ 14,895	\$ 14,895			\$ 24,175	* Current Market Affect
22	10E	Lockers	\$ 5,258	\$ 4,121	\$ 1,137	\$ 1,137				* Current Market Affect
23	10G	Metal Canopy	\$ -	\$ 153,285	\$ (153,285)		\$ (153,285)			* Canopy Detail as Concrete in lieu of Steel - Questionable on Earlier Estimate
24	10L	Toilet Accessories & Partitions	\$ 23,949	\$ 14,918	\$ 9,031	\$ 9,031				* Current Market Affect * Used Specified
25	11A	General Equipment	\$ 8,956	\$ 8,120	\$ 836	\$ 836				* Current Market Affect
26	11I	Residential Appliances	\$ -	\$ 3,571	\$ (3,571)		\$ (3,571)			* Deleted Appliances (By Owner)
27	12E	Rugs & Mats	\$ -	\$ 3,632	\$ (3,632)		\$ (3,632)			* No Rugs / Mats Shown - Deleted
28	21A	Fire Protection	\$ 128,905	\$ 126,402	\$ 2,503	\$ 2,503				* Current Market Affect
29	22A	Plumbing	\$ 172,464	\$ 175,400	\$ (2,936)	\$ (2,936)			\$ 167,415	* Current Market Affect



**BUILD IN
GOOD COMPANY.**

Estimate Summary

Project Name: PBC West Atlantic Branch Library
 Job Number: PBC #03212; TWC #F103300
 Estimate Date: 22MAY2006 Rev 1a

Gross Area (GSF): 34,586 GSF
 Estimate Status: 95% GMP
 Addenda: N/A

Line No.	Bid Ticket	Trade Description	95% CD/GMP (5/22/06 Rev 1a)	50% CD (12/19/05)	Variance	Variance			SBE	Comments
						Market Adjustment	Scope Adjustments	Estimate Adjustments		
30	23A	HVAC	\$ 730,648	\$ 710,497	\$ 20,151	\$ 20,151			\$ 722,528	* Current Market Affect * Use of SBE Subcontractor
31	26A	Electrical	\$ 1,189,428	\$ 966,520	\$ 222,908	\$ 172,908	\$ 50,000			* Current Market Affect * Addition of CATV 'complete'
32	31A	Earthwork	\$ 347,089	\$ 551,370	\$ (204,281)	\$ (129,281)	\$ (75,000)			* Final Dwg Det resulted in Firmer Pricing * Reduced Imported Fill
33	32A	Paving, Curbing & Signage	\$ 764,932	\$ 666,962	\$ 97,970	\$ 97,970				* Final Dwg Det resulted in Firmer Pricing
34	32B	Pavers	\$ 4,636	\$ -	\$ 4,636		\$ 4,636			* Added Pavers at Parking Lot Islands
35	32C	Site Improvements	\$ 1,097	\$ 1,827	\$ (730)	\$ (730)				* Current Market Affect
36	32E	Landscape & Irrigation	\$ 344,586	\$ 362,101	\$ (17,515)	\$ (17,515)				* Current Market Affect
37	32F	Fencing	\$ 13,632	\$ 28,012	\$ (14,380)			\$ (14,380)		* Use of Lake & Permanent Fence as Barrier
38	33A	Site Utilities	\$ 372,424	\$ 444,474	\$ (72,050)		\$ (72,050)			* Deletion of Jack & Bore under Hagen Ranch Road
SUBTOTAL			\$ 8,823,906	\$ 8,881,424	\$ (57,518)	\$ 37,563	\$ (114,821)	\$ 19,740	\$ 1,887,230	
Permits			By Owner		By Owner		19%			
General Liability Insurance			1.055%	\$ 107,084	\$ 108,961	\$ (1,877)	Percentage of SBE			
Builders Risk Insurance			0.675%	\$ 68,513	\$ 71,755	\$ (3,242)	(Based on Total Project Costs)			
Performance Bond			0.800%	\$ 81,201	\$ 85,043	\$ (3,842)				
Tax Savings (Allowance)			1.000%	\$ (101,501)	\$ -	\$ (101,501)				
Escalation			4.000%	\$ 406,004	\$ 532,886	\$ (126,882)				
Contractor Contingency			3.000%	\$ 281,556	\$ 444,071	\$ (162,515)				
Construction Fee			5.000%	\$ 483,338	\$ 506,207	\$ (22,869)				
TOTAL PROJECT			\$ 10,150,101	\$ 10,630,347	\$ (480,246)					
Scope & Value Tracking			\$ -	\$ 11,969	\$ (11,969)					
TOTAL PROJECT w/ Additions			\$ 10,150,101	\$ 10,642,316	\$ (492,215)					
Cost Per GSF			\$ 293.47	\$ 307.71	\$ (14.23)					

SCHEDULE 1
LIST OF PROPOSED "SBE" SUBCONTRACTORS

PROJECT NAME: Palm Beach County West Atlantic (Hagen Ranch) Branch Library; Phase #2 PROJECT NO. 03213
 NAME OF PRIME: The Weitz Company, Inc. PHONE NO: 561-686-5511 FAX NO: 561-686-7774
 CONTACT PERSON: Brad Sterling, Estimator

PLEASE IDENTIFY ALL APPLICABLE CATEGORIES OF SUBCONTRACTORS

	Name & Address	Trade	Value
1	Top Notch, Inc; West Palm Beach, Florida	Concrete	\$ 97,141
2	Palm Beach Glass Specialties, Inc.; West Palm Beach, Florida	Storefront & Glazing	\$ 226,235
3	Ralph Della-Pietra, Inc; Jupiter, Florida	Drywall	\$ 419,129
4	Jack Walsh & Rugs, Inc; West Palm Beach, Florida	Carpet & Resilient Flooring	\$ 151,868
5	Fleischer's, Inc; West Palm Beach, Florida	Painting	\$ 78,739
6	Baron Sign Manufacturing; Riviera Beach, Florida	Signage	\$ 24,175
7	ISI; Boynton Beach, Florida	Plumbing	\$ 167,415
8	Horizon Air Conditioning, Inc; West Palm Beach, Florida	HVAC	\$ 722,528

(Please use additional sheets if necessary) **Total \$ 1,887,230**

Total Bid Price \$ 10,150,101 **Total % of SBE Participation 18.59%**

- Note:
- 1 The amounts listed on this form must be supported by the Subcontractors prices included on Schedule 2 in order to be counted toward goal attainment.
 - 2 Firms may be certified by Palm Beach County as an SBE and/or M/WBE.
 - 3 M/WBE information is being collected for tracking purposes only.



May 10, 2006

Telephone: 415-981-0600
Fax: 415-982-7978
Website: www.willis.com

Palm Beach County
3200 Belvedere Road
Building 1169
West Palm Beach, FL 33406

Direct Line: 415-955-0156
Direct Fax: 415-982-7978
E-mail: bill.phillips@willis.com

**RE: The Weitz Company, LLC
West Atlantic (Hagen Ranch) Library – Delray Beach, FL**

We are pleased to write to you at the request of our client, The Weitz Company, LLC.

The Weitz Company, LLC is a highly regarded and valued client of Willis and we are privileged to provide their bonding requirements. Their financial strength and management capabilities have qualified them to bond any project they have chosen to undertake. We have received approval on bonds on individual projects in excess of \$100,000,000 with a total bonding capacity of \$1,000,000,000.

We have surety credit established with Federal Insurance Company of Warren, NJ, which is A. M. Best rated A++ (Superior) FSC XV, Fidelity and Deposit Company of Maryland of Baltimore, MD which is A. M. Best rated A (Excellent) FSC XV, and Zurich American Insurance Company of Schaumburg, IL which is A. M. Best rated A (Excellent) FSC XV, all of which are listed in the Federal Register.

We understand that the captioned project is in the \$11,000,000 range. We anticipate no problem providing a 100% Performance and Payment Bond should the Weitz Company, LLC be awarded this contract. The approval of any final bonds would be subject to the review of the contract terms and conditions by our client and their sureties, as well as normal underwriting procedures at the time the bond is required.

The Weitz Company, LLC has an excellent reputation in the construction industry and is ranked among the top 25 builders in the United States with annual revenues exceeding \$1 Billion. We have never had any complaints from owners or architects in regard to their work.

If you need further information concerning this fine contractor, please do not hesitate to contact me directly at (415) 955-0156.

Very Truly Yours,

William Phillips, Jr.
Vice President – Surety Division

Willis Insurance Services of California,
Inc.
One Bush Street
San Francisco, CA 94104-4415
0371719

FORM OF GUARANTEE

GUARANTEE FOR (Contractor and Surety Name) _____

We the undersigned hereby guarantee that the (**Hagen Ranch Road Library, Project No. 03213**) Palm Beach County, Florida, which we have constructed and bonded, has been done in accordance with the plans and specifications; that the work constructed will fulfill the requirements of the guaranties included in the Contract Documents. We agree to repair or replace any or all of our work, together with any work of others which may be damaged in so doing, that may prove to be defective in the workmanship or materials within a period of one year from the date of Substantial Completion of all of the above named work by the County of Palm Beach, State of Florida, without any expense whatsoever to said County of Palm Beach, ordinary wear and tear and unusual abuse or neglect excepted by the County. When correction work is started, it shall be carried through to completion.

In the event of our failure to acknowledge notice, and commence corrections of defective work within five (5) working days after being notified in writing by the Board of County Commissioners, Palm Beach County, Florida, we, collectively or separately, do hereby authorize Palm Beach County to proceed to have said defects repaired and made good at our expense and we will honor and pay the costs and charges therefore upon demand.

DATED _____
(Date of substantial completion)

SEAL AND NOTARIAL ACKNOWLEDGMENT OF SURETY

(Contractor) (Seal)

By: _____
(Signature)

(Surety) (Seal)

By: _____
(Signature)

ACORD EVIDENCE OF PROPERTY INSURANCE

DATE (MM/DD/YY)
04/27/2006

THIS IS EVIDENCE THAT INSURANCE AS IDENTIFIED BELOW HAS BEEN ISSUED, IS IN FORCE, AND CONVEYS ALL THE RIGHTS AND PRIVILEGES AFFORDED UNDER THE POLICY.

PRODUCER Willis of Minnesota, Inc. 4000 Olson Memorial Highway, Suite 300 Minneapolis, MN 55422	PHONE (A/R, M, E, B) 763.302.7100	COMPANY ACE Fire Underwriters Insurance Company
CODE: AGENCY CUSTOMER ID #	SUB CODE	
INSURED The Weitz Company, LLC Capital Square 400 Locust St., Suite 300 Des Moines, IA 50309	LOAN NUMBER	POLICY NUMBER I20796698001
	EFFECTIVE DATE 06/01/2005	EXPIRATION DATE *See Below
	CONTINUED UNTIL TERMINATED IF CHECKED <input type="checkbox"/>	
THIS REPLACES PRIOR EVIDENCE DATED:		

PROPERTY INFORMATION

LOCATION/DESCRIPTION
Project: West Atlantic (Hagen Ranch) Branch Library, 14276 Hagen Ranch Road, Delray Beach FL 33446
Start Date: 07/01/06 Completion Date: 07/01/07 Contract Amt: \$11,000,000.00 Type of Construction:
*Expiration Date: Earlier of Substantial Completion or 07/01/2007

COVERAGE INFORMATION

COVERAGE PERILS/FORMS	AMOUNT OF INSURANCE	DEDUCTIBLE
Project Limit Builders Risk - "All-Risk" Coverage, Replacement cost with like, kind, & quality	Completed Value	\$ 10,000 AOP
Flood: \$25,000,000 occurrence/annual aggregate, except \$5,000,000 occurrence/annual aggregate for projects in Flood Zone "A" Flood Deductibles: \$50,000; Zone B - \$250,000; Zone A and V - \$500,000 minimum		
Earthquake: \$25,000,000 occurrence/annual aggregate, except \$5,000,000 occurrence/annual aggregate for Zone 2 & 3 and New Madrid and \$5,000,000 occurrence/annual aggregate for California and all Zone 1 \$10,000,000 occurrence/annual aggregate for Pacific Northwest and New Madrid Earthquake Deductible: \$25,000-except: Pacific Northwest and New Madrid 2% VATOL, with minimum \$100,000 All California and Zone 2% VATOL with minimum \$250,000		
Coastal Windstorm: All Florida and Hawaii \$15,000,000 with 2% VATOL, \$250,000 minimum deductible All Other Coastal counties from Texas to Virginia \$15,000,000 with 2% VATOL, \$100,000 minimum deductible		
Includes Property in Transit, Property at a location other than the job site	\$1,000,000	\$ 10,000

REMARKS (Including Special Conditions)

It is hereby agreed that PALM BEACH COUNTY BOARD OF COUNTY COMMISSIONERS, A POLITICAL SUBDIVISION OF THE STATE OF FLORIDA, ITS OFFICERS, AGENTS AND EMPLOYEES are included as Additional Insureds under the Builder's Risk policy as respects work performed by the named insured on the referenced project. Palm Beach County Commissioners is named as Loss Payee as respects work performed by the named insured on the referenced project.

CANCELLATION

THE POLICY IS SUBJECT TO THE PREMIUMS, FORMS, AND RULES IN EFFECT FOR EACH POLICY PERIOD. SHOULD THE POLICY BE TERMINATED, THE COMPANY WILL GIVE THE ADDITIONAL INTEREST IDENTIFIED BELOW 60 DAYS WRITTEN NOTICE, AND WILL SEND NOTIFICATION OF ANY CHANGES TO THE POLICY THAT WOULD AFFECT THAT INTEREST, IN ACCORDANCE WITH THE POLICY PROVISIONS OR AS REQUIRED BY LAW.

ADDITIONAL INTEREST

NAME AND ADDRESS PALM BEACH COUNTY CAPITAL IMPROVEMENT DIVISION ATTN: BILL DEBECK, PROJECT MANAGER 3323 BELVEDERE ROAD, BLDG #503	MORTGAGEE <input checked="" type="checkbox"/>	ADDITIONAL INSURED <input checked="" type="checkbox"/>
	LOSS PAYEE <input checked="" type="checkbox"/>	
	LOAN #	
AUTHORIZED REPRESENTATIVE 		

ACORD CERTIFICATE OF LIABILITY INSURANCE

DATE (MM/DD/YY)
04/27/06

PRODUCER
James Murphy & Assoc - WDM
1-800-247-7756
P.O. Box 9207
Des Moines, IA 50306-9207

THIS CERTIFICATE IS ISSUED AS A MATTER OF INFORMATION ONLY AND CONFERS NO RIGHTS UPON THE CERTIFICATE HOLDER. THIS CERTIFICATE DOES NOT AMEND, EXTEND OR ALTER THE COVERAGE AFFORDED BY THE POLICIES BELOW.

INSURERS AFFORDING COVERAGE

INSURED
The Weitz Company, LLC
400 Locust Street, Suite 300
Des Moines, IA 50309

INSURER A: Zurich American Insurance Co.
INSURER B:
INSURER C:
INSURER D:
INSURER E:

COVERAGES

THE POLICIES OF INSURANCE LISTED BELOW HAVE BEEN ISSUED TO THE INSURED NAMED ABOVE FOR THE POLICY PERIOD INDICATED. NOTWITHSTANDING ANY REQUIREMENT, TERM OR CONDITION OF ANY CONTRACT OR OTHER DOCUMENT WITH RESPECT TO WHICH THIS CERTIFICATE MAY BE ISSUED OR MAY PERTAIN, THE INSURANCE AFFORDED BY THE POLICIES DESCRIBED HEREIN IS SUBJECT TO ALL THE TERMS, EXCLUSIONS AND CONDITIONS OF SUCH POLICIES. AGGREGATE LIMITS SHOWN MAY HAVE BEEN REDUCED BY PAID CLAIMS.

INSR LTR	TYPE OF INSURANCE	POLICY NUMBER	POLICY EFFECTIVE DATE (MM/DD/YY)	POLICY EXPIRATION DATE (MM/DD/YY)	LIMITS								
	GENERAL LIABILITY <input type="checkbox"/> COMMERCIAL GENERAL LIABILITY <input type="checkbox"/> CLAIMS MADE <input type="checkbox"/> OCCUR GEN'L AGGREGATE LIMIT APPLIES PER: <input type="checkbox"/> POLICY <input type="checkbox"/> PRO-JECT <input type="checkbox"/> LOC				EACH OCCURRENCE \$ FIRE DAMAGE (Any one fire) \$ MED EXP (Any one person) \$ PERSONAL & ADV INJURY \$ GENERAL AGGREGATE \$ PRODUCTS - COMP/OP AGG \$								
A	AUTOMOBILE LIABILITY <input checked="" type="checkbox"/> ANY AUTO <input type="checkbox"/> ALL OWNED AUTOS <input type="checkbox"/> SCHEDULED AUTOS <input checked="" type="checkbox"/> HIRED AUTOS <input checked="" type="checkbox"/> NON-OWNED AUTOS	BAP937413102	06/01/05	06/01/06	COMBINED SINGLE LIMIT (Ea accident) \$ 100000 BODILY INJURY (Per person) \$ BODILY INJURY (Per accident) \$ PROPERTY DAMAGE (Per accident) \$								
	GARAGE LIABILITY <input type="checkbox"/> ANY AUTO				AUTO ONLY - EA ACCIDENT \$ OTHER THAN EA ACC \$ AUTO ONLY: AGG \$								
	EXCESS LIABILITY <input type="checkbox"/> OCCUR <input type="checkbox"/> CLAIMS MADE DEDUCTIBLE RETENTION \$				EACH OCCURRENCE \$ AGGREGATE \$ \$ \$ \$								
	WORKERS COMPENSATION AND EMPLOYERS' LIABILITY				<table border="1"> <tr> <td>WC STATU-TORY LIMITS</td> <td>OTH-ER</td> </tr> <tr> <td>E.L. EACH ACCIDENT</td> <td>\$</td> </tr> <tr> <td>E.L. DISEASE - EA EMPLOYEE</td> <td>\$</td> </tr> <tr> <td>E.L. DISEASE - POLICY LIMIT</td> <td>\$</td> </tr> </table>	WC STATU-TORY LIMITS	OTH-ER	E.L. EACH ACCIDENT	\$	E.L. DISEASE - EA EMPLOYEE	\$	E.L. DISEASE - POLICY LIMIT	\$
WC STATU-TORY LIMITS	OTH-ER												
E.L. EACH ACCIDENT	\$												
E.L. DISEASE - EA EMPLOYEE	\$												
E.L. DISEASE - POLICY LIMIT	\$												
	OTHER				\$ \$ \$								

DESCRIPTION OF OPERATIONS/LOCATIONS/VEHICLES/EXCLUSIONS ADDED BY ENDORSEMENT/SPECIAL PROVISIONS
 WEITZ FLORIDA: WEST ATLANTIC (HAGEN RANCH) BRANCH LIBRARY, F103300: PALM BEACH COUNTY BOARD OF COUNTY COMMISSIONERS, A POLITICAL SUBDIVISION OF THE STATE OF FLORIDA, ITS OFFICERS, AGENTS AND EMPLOYEES ARE NAMED AS ADDITIONAL INSUREDS AS RESPECTS AUTO COVERAGE FOR THE WEST ATLANTIC (HAGEN RANCH) BRANCH LIBRARY PROJECT. WAIVER OF SUBROGATION APPLIES FOR AUTO COVERAGE.

CERTIFICATE HOLDER

ADDITIONAL INSURED; INSURER LETTER:

CANCELLATION

SHOULD ANY OF THE ABOVE DESCRIBED POLICIES BE CANCELLED BEFORE THE EXPIRATION DATE THEREOF, THE ISSUING INSURER WILL ENDEAVOR TO MAIL 30 DAYS WRITTEN NOTICE TO THE CERTIFICATE HOLDER NAMED TO THE LEFT, BUT FAILURE TO DO SO SHALL IMPOSE NO OBLIGATION OR LIABILITY OF ANY KIND UPON THE INSURER, ITS AGENTS OR REPRESENTATIVES.

AUTHORIZED REPRESENTATIVE

Daniel A. Kennedy

Palm Beach County
c/o Capital Improvements Div.
13 Belvedere Road, Bldg. 503
West Palm Beach, FL 33406

USA

ACORD 25-S (7/97) 577025
4232847

© ACORD CORPORATION 1988

IMPORTANT

If the certificate holder is an **ADDITIONAL INSURED**, the policy(ies) must be endorsed. A statement on this certificate does not confer rights to the certificate holder in lieu of such endorsement(s).

If **SUBROGATION IS WAIVED**, subject to the terms and conditions of the policy, certain policies may require an endorsement. A statement on this certificate does not confer rights to the certificate holder in lieu of such endorsement(s).

DISCLAIMER

The Certificate of Insurance on the reverse side of this form does not constitute a contract between the issuing insurer(s), authorized representative or producer, and the certificate holder, nor does it affirmatively or negatively amend, extend or alter the coverage afforded by the policies listed thereon.

ACORD CERTIFICATE OF LIABILITY INSURANCE

DATE (MM/DD/YYYY)
04/27/2006

PRODUCER ACIG INSURANCE AGENCY, INC.
12222 MERIT DRIVE, SUITE 1660
DALLAS, TX 75251-0000
(972) 702-9004

THIS CERTIFICATE IS ISSUED AS A MATTER OF INFORMATION ONLY AND CONFERS NO RIGHTS UPON THE CERTIFICATE HOLDER. THIS CERTIFICATE DOES NOT AMEND, EXTEND OR ALTER THE COVERAGE AFFORDED BY THE POLICIES BELOW.

INSURED THE WEITZ COMPANY
400 LOCUST STREET, SUITE 300
DES MOINES IA 50309

INSURERS AFFORDING COVERAGE	NAIC#
INSURER A: AMERICAN CONTRACTORS INS. CO. RR	19984
INSURER B: ACIG INSURANCE COMPANY	19984
INSURER C: AMERICAN GUARANTEE & LIAB INS. CO	26247
INSURER D:	
INSURER E:	

COVERAGES

THE POLICIES OF INSURANCE LISTED BELOW HAVE BEEN ISSUED TO THE INSURED NAMED ABOVE FOR THE POLICY PERIOD INDICATED. NOTWITHSTANDING ANY REQUIREMENT, TERM OR CONDITION OF ANY CONTRACT OR OTHER DOCUMENT WITH RESPECT TO WHICH THIS CERTIFICATE MAY BE ISSUED OR MAY PERTAIN, THE INSURANCE AFFORDED BY THE POLICIES DESCRIBED HEREIN IS SUBJECT TO ALL THE TERMS, EXCLUSIONS AND CONDITIONS OF SUCH POLICIES. AGGREGATE LIMITS SHOWN MAY HAVE BEEN REDUCED BY PAID CLAIMS.

INSR LTR	ADD'L INSD	TYPE OF INSURANCE	POLICY NUMBER	POLICY EFFECTIVE DATE (MM/DD/YYYY)	POLICY EXPIRATION DATE (MM/DD/YYYY)	LIMITS
A		GENERAL LIABILITY <input checked="" type="checkbox"/> COMMERCIAL GENERAL LIABILITY <input type="checkbox"/> CLAIMS MADE <input checked="" type="checkbox"/> OCCUR GEN'L AGGREGATE LIMIT APPLIES PER: <input type="checkbox"/> POLICY <input checked="" type="checkbox"/> PRO-JECT <input type="checkbox"/> LOC	GR05036005	06/01/05	06/01/06	EACH OCCURRENCE \$ 2,000,000 DAMAGE TO RENTED PREMISES (Ea occurrence) \$ 100,000 MED EXP (Any one person) \$ 5,000 PERSONAL & ADV INJURY \$ 2,000,000 GENERAL AGGREGATE \$ 4,000,000 PRODUCTS - COMP/OP AGG \$ 4,000,000
		AUTOMOBILE LIABILITY <input type="checkbox"/> ANY AUTO <input type="checkbox"/> ALL OWNED AUTOS <input type="checkbox"/> SCHEDULED AUTOS <input type="checkbox"/> HIRED AUTOS <input type="checkbox"/> NON-OWNED AUTOS 1283				COMBINED SINGLE LIMIT (Ea Accident) \$ BODILY INJURY (Per person) \$ BODILY INJURY (Per accident) \$ PROPERTY DAMAGE (Per accident) \$
		GARAGE LIABILITY <input type="checkbox"/> ANY AUTO				AUTO ONLY - EA ACCIDENT \$ OTHER THAN AUTO ONLY: EA ACC \$ AGG \$
C		EXCESS/UMBRELLA LIABILITY <input checked="" type="checkbox"/> OCCUR <input type="checkbox"/> CLAIMS MADE <input type="checkbox"/> DEDUCTIBLE <input type="checkbox"/> RETENTION \$				EACH OCCURRENCE \$ AGGREGATE \$ \$ \$ \$
B		WORKERS COMPENSATION AND EMPLOYERS' LIABILITY ANY PROPRIETOR/PARTNER/EXECUTIVE OFFICER/MEMBER EXCLUDED? If yes, describe under SPECIAL PROVISIONS below	WD05036053 WD05036054 WR05036018	06/01/05 06/01/05 06/01/05	06/01/06 06/01/06 06/01/06	<input checked="" type="checkbox"/> WC STATIL-TORY LIMITS <input type="checkbox"/> OTH-ER E.L. EACH ACCIDENT \$ 1,000,000 E.L. DISEASE - EA EMPLOYEE \$ 1,000,000 E.L. DISEASE - POLICY LIMIT \$ 1,000,000
		OTHER				

DESCRIPTION OF OPERATIONS/LOCATIONS/VEHICLES/EXCLUSIONS ADDED BY ENDORSEMENT/SPECIAL PROVISIONS
 WEITZ FLORIDA: WEST ATLANTIC (HAGEN RANCH) BRANCH LIBRARY, F103300: PALM BEACH COUNTY BOARD OF COUTY COMMISSIONERS, A POLITICAL SUBDIVISION OF THE STATE OF FLORIDA, ITS OFFICERS, AGENTS AND EMPLOYEES ARE NAMED AS ADDITIONAL INSURED AS RESPECTS GENERAL LIABILITY COVERAGE FOR THE WEST ATLANTIC (HAGEN RANCH) BRANCH LIBRARY PROJECT. WAIVER OF SUBROGATION APPLIES FOR WORKERS COMPENSATION COVERAGE AND GENERAL LIABILITY COVERAGE.

CERTIFICATE HOLDER

PALM BEACH COUNTY CAPITAL IMPROVEMENT DIVISION
 ATTN BILL DEBECK, PROJECT MANAGER
 3323 BELVEDERE ROAD, BLDG #503
 WEST PALM BEACH FL 33406

CANCELLATION Certificate ID 30,611

SHOULD ANY OF THE ABOVE DESCRIBED POLICIES BE CANCELLED BEFORE THE EXPIRATION DATE THEREOF, THE ISSUING INSURER WILL ENDEAVOR TO MAIL 30 DAYS WRITTEN NOTICE TO THE CERTIFICATE HOLDER NAMED TO THE LEFT, BUT FAILURE TO DO SO SHALL IMPOSE NO OBLIGATION OR LIABILITY OF ANY KIND UPON THE INSURER, ITS AGENTS OR REPRESENTATIVES.

AUTHORIZED REPRESENTATIVE

Michael J. O'Neill

MICHAEL J. O'NEILL

