



**II. FISCAL IMPACT ANALYSIS**

**A. Five Year Summary of Fiscal Impact:**

Fiscal Years	2016	2017	2018	2019	2020
Capital Expenditures	<u>\$965,133</u>	<u>-0-</u>	<u>-0-</u>	<u>-0-</u>	<u>-0-</u>
Operating Costs	<u>-0-</u>	<u>-0-</u>	<u>-0-</u>	<u>-0-</u>	<u>-0-</u>
Grant Revenues	<u>(\$694,751)</u>	<u>-0-</u>	<u>-0-</u>	<u>-0-</u>	<u>-0-</u>
Program Income (County)	<u>-0-</u>	<u>-0-</u>	<u>-0-</u>	<u>-0-</u>	<u>-0-</u>
In-Kind Match (County)	<u>-0-</u>	<u>-0-</u>	<u>-0-</u>	<u>-0-</u>	<u>-0-</u>
NET FISCAL IMPACT	<u>\$270,382</u>	<u>-0-</u>	<u>-0-</u>	<u>-0-</u>	<u>-0-</u>
# ADDITIONAL FTE POSITIONS (Cumulative)	_____	_____	_____	_____	_____

Is Item Included in Current Budget?            Yes                    No    X

**Budget Account No:**

Fund 3900    Dept 366            Unit X168            Object 6551

**Recommended Sources of Funds/Summary of Fiscal Impact:**

Capital Outlay Fund

L-10 Canal Improvement Project

Construction Contract	\$811,585.00
Contingency	\$ 24,348.00
Testing Lab	\$ 70,000.00
Streetscape (Trees, Irrigation, Sod)	\$ 2,500.00
Staff Costs	
-Roadway Production	\$ 16,200.00
-Survey Section	\$ 8,100.00
-Construction Coordination	\$ 32,400.00
	\$965,133.00
Federal Grant FM 433169-1-58-01	(\$694,751.00)
FISCAL IMPACT	\$270,382.00

A budget amendment of \$694,751 in the Capital Outlay Fund to recognize Federal LAP agreement with FDOT and appropriate it to this project was approved by the BOCC on January 26, 2016, BA2016-0296.

**C. Departmental Fiscal Review:**

Alicia Kovalainen

**III. REVIEW COMMENTS**

**A. OFMB Fiscal and/or Contract Dev. and Control Comments:**

[Signature] 7/20/16  
ASD  
7/20  
OFMB 8/7/20

[Signature] 8/3/16  
Contract Dev. and Control  
8/3/16 (T)

**B. Approved as to Form and Legal Sufficiency:**

[Signature] 8/24/16  
Assistant County Attorney

**C. Other Department Review:**

\_\_\_\_\_  
Department Director

**This summary is not to be used as a basis for payment.**

**PROJECT LOCATION  
CANAL POINT PEDESTRIAN BRIDGE  
PALM BEACH COUNTY PROJECT #2013601**

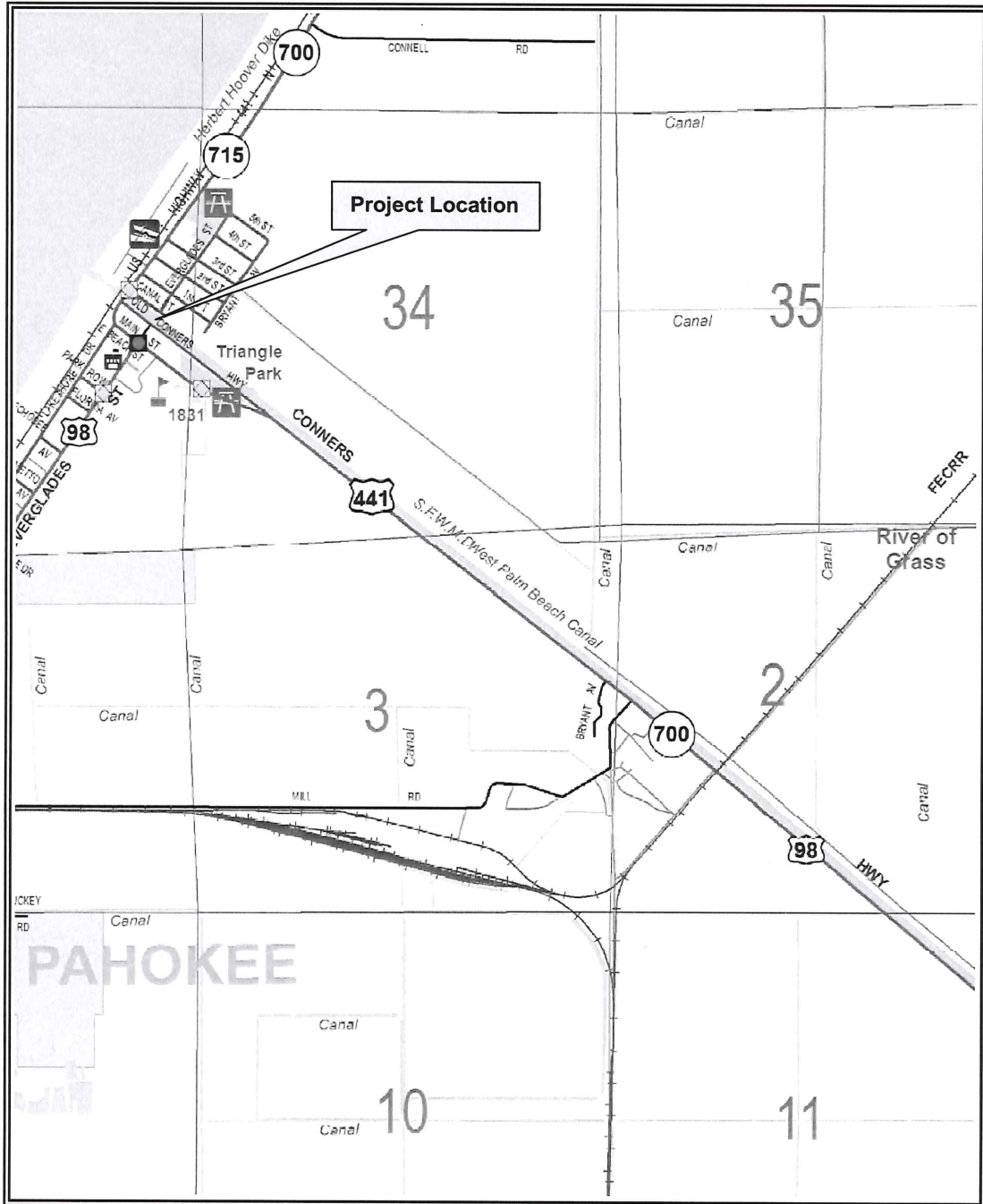

Township 41, Range 37, Section 33

LOCATION MAP

**CONTRACT**

STATE OF FLORIDA )

) SS

COUNTY OF PALM BEACH )

This Contract, made this \_\_\_\_ day of \_\_\_\_\_, A.D. 2016, by and between PALM BEACH COUNTY, a Political Subdivision of the State of Florida, (hereinafter "County"), and West Construction, Inc. of West Palm Beach, Florida, and their heirs, executors, administrators and assigns, (hereinafter "Contractor"):

WITNESSETH: The Contractor agrees with the County, for the consideration herein mentioned at their own proper cost and expense to do all the work and furnish all necessary labor, materials, equipment, machinery, tools, apparatus, services, state workmen's compensation and unemployment compensation taxes incurred in the performance of the contract, and means of transportation for the complete construction of:

**PROJECT NAME: CANAL POINT PEDESTRIAN BRIDGE**

**PROJECT NO.: 2013601**

IN THE AMOUNT OF:

EIGHT HUNDRED ELEVEN THOUSAND FIVE HUNDRED EIGHTY FIVE DOLLARS 00/100

---

(IN WORDS)

\$811,585.00

(IN FIGURES)

in Palm Beach County, Florida, in the manner and to the full extent as set forth in the Contract Documents therefore and the Contract Documents relative thereto, are made a part of this Agreement as completely as if set forth herein, to the satisfaction of the County, or its duly authorized representative.

The Contractor further agrees for the consideration herein mentioned to commence the work with adequate forces and equipment within fourteen (14) calendar days of the date set forth in the "Notice to Proceed". The time limit for the completion of all work under this contract shall be one hundred fifty (150) calendar days, (see Special Provisions). The date fixing this period upon the calendar shall be established and stated in the "Notice to Proceed". After commencement of the work, it shall be properly dispatched toward completion, to the satisfaction of the Engineer, and shall be fully completed within the time limit. It is understood and agreed that the time limit for completion of said work is the essence of the contract and should the Contractor fail to complete the work within the time limit, it is agreed that for such calendar day that any work provided for in these Contract Documents shall remain incomplete after the time limit has expired, including any official extension of the time limit; the sum per day given in the contained schedules shall be deducted from monies due the Contractor, not as a penalty, but as liquidated damages (in accordance with Section 8-10.2 of the Standard Specifications) and added expense for supervision.

The Contractor shall take into account all contingent work which has to be done by other parties arising from any cause whatsoever, and shall not plead his want of knowledge of such contingent work as an excuse for delay in his work, or for its non-performance.

IN WITNESS WHEREOF, the parties have caused this Contract to be executed and sealed the day and year first written above.

ATTEST:

SHARON R. BOCK,  
Clerk & Comptroller

PALM BEACH COUNTY, FLORIDA, a  
Political Subdivision of the  
State of Florida

BOARD OF COUNTY COMMISSIONERS

By: \_\_\_\_\_  
Deputy Clerk

By: \_\_\_\_\_  
Mary Lou Berger, Mayor

APPROVED AS TO FORM  
AND LEGAL SUFFICIENCY



(witness signature)

Matthew F. West

(witness name printed)  
Secretary

\_\_\_\_\_  
(witness signature)

\_\_\_\_\_  
(witness name printed)

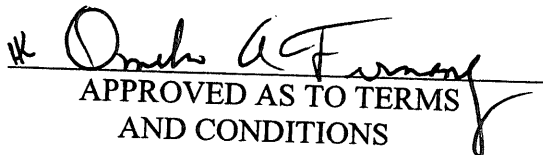
#   
APPROVED AS TO TERMS  
AND CONDITIONS

WEST CONSTRUCTION, INC.

\_\_\_\_\_  
(Corporate Name)

a Florida corporation  
(insert state of incorporation)

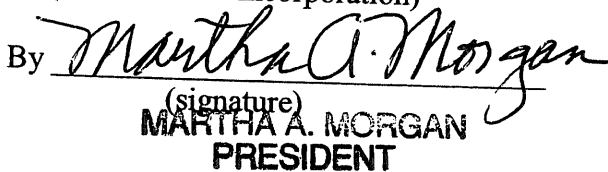
By   
(signature)  
MARTHA A. MORGAN  
PRESIDENT

\_\_\_\_\_  
(print signatory's name)

Its \_\_\_\_\_  
(print title)

\_\_\_\_\_  
(date)

(Corporate Seal)

CANAL POINT PEDESTRIAN BRIDGE

PBC PROJECT #2013601

				AVERAGE OF BID ITEMS	ENGINEERS ESTIMATE	WEST CONSTRUCTION, INC.		MURRAY LOGAN CONSTRUCTION, INC.		DOUGLAS N. HIGGINS, INC.	
ITEM #	DESCRIPTION	QTY	UNIT	UNIT PRICE	UNIT PRICE	UNIT PRICE	TOTAL	UNIT PRICE	TOTAL	UNIT PRICE	TOTAL
<b>REGULAR PAY ITEMS</b>											
1	Mobilization	1	LS	\$ 130,421.33	\$ 50,000.00	\$ 153,300.00	\$ 153,300.00	\$ 134,000.00	\$ 134,000.00	\$ 100,000.00	\$ 100,000.00
2	Maintenance of Traffic (MOT)	1	LS	\$ 66,775.00	\$ 3,000.00	\$ 3,150.00	\$ 3,150.00	\$ 6,500.00	\$ 6,500.00	\$ 50,000.00	\$ 50,000.00
3	Clearing and Grubbing	1	LS	\$ 7,646.67	\$ 10,000.00	\$ 2,140.00	\$ 2,140.00	\$ 6,000.00	\$ 6,000.00	\$ 20,000.00	\$ 20,000.00
4	Earthwork	1	LS	\$ 14,670.83	\$ 15,000.00	\$ 3,900.00	\$ 3,900.00	\$ 10,000.00	\$ 10,000.00	\$ 47,000.00	\$ 47,000.00
5	Cabbage Palmetto / Sabal Palmetto	18	EA	\$ 730.17	\$ 190.00	\$ 236.00	\$ 4,248.00	\$ 650.00	\$ 11,700.00	\$ 255.00	\$ 4,590.00
6	Mini Pine Nugget Mulch	6	CY	\$ 177.33	\$ 85.00	\$ 40.00	\$ 240.00	\$ 150.00	\$ 900.00	\$ 59.00	\$ 354.00
7	Bahia Sod	9,600	SF	\$ 0.82	\$ 0.20	\$ 0.55	\$ 5,280.00	\$ 1.00	\$ 9,600.00	\$ 0.30	\$ 2,880.00
8	Sidewalk Ramp Wall	38	CY	\$ 861.67	\$ 791.00	\$ 930.00	\$ 35,340.00	\$ 1,500.00	\$ 57,000.00	\$ 600.00	\$ 22,800.00
9	6" Thick Class II Concrete Deck	134	SY	\$ 124.00	\$ 85.00	\$ 64.00	\$ 8,576.00	\$ 195.00	\$ 26,130.00	\$ 230.00	\$ 30,820.00
10	Class IV Concrete (Substructure)	11	CY	\$ 1,617.67	\$ 1,141.00	\$ 1,006.00	\$ 11,066.00	\$ 1,500.00	\$ 16,500.00	\$ 2,455.00	\$ 27,005.00
11	Reinforcing Steel - Substructure	2,329	LB	\$ 2.17	\$ 0.85	\$ 1.00	\$ 2,329.00	\$ 2.00	\$ 4,658.00	\$ 2.50	\$ 5,822.50
12	Reinforcing Steel - Sidewalk ramp	8,545	LB	\$ 2.01	\$ 0.85	\$ 1.00	\$ 8,545.00	\$ 2.00	\$ 17,090.00	\$ 2.70	\$ 23,071.50
13	14" Pre-Stressed Piles	186	LF	\$ 253.67	\$ 75.00	\$ 258.00	\$ 47,988.00	\$ 185.00	\$ 34,410.00	\$ 100.00	\$ 18,600.00
14	18" Pre-Stressed Piles	163	LF	\$ 413.00	\$ 81.62	\$ 405.00	\$ 66,015.00	\$ 235.00	\$ 38,305.00	\$ 128.00	\$ 20,864.00
15	14" Pre-Stressed Test Piles with PDA	92	LF	\$ 531.33	\$ 125.00	\$ 258.00	\$ 23,736.00	\$ 300.00	\$ 27,600.00	\$ 360.00	\$ 33,120.00
16	18" Pre-Stressed Test Piles with PDA	194	LF	\$ 644.17	\$ 158.88	\$ 405.00	\$ 78,570.00	\$ 400.00	\$ 77,600.00	\$ 360.00	\$ 69,840.00
17	Pedestrian Bridge	1	LS	\$ 368,019.50	\$ 300,000.00	\$ 282,517.00	\$ 282,517.00	\$ 348,200.00	\$ 348,200.00	\$ 407,000.00	\$ 407,000.00
18	Guiderail (FDOT Index 880)	155	LF	\$ 72.83	\$ 50.00	\$ 75.00	\$ 11,625.00	\$ 85.00	\$ 13,175.00	\$ 64.00	\$ 9,920.00
19	Railing (FDOT Index 861)	300	LF	\$ 100.33	\$ 138.23	\$ 36.00	\$ 10,800.00	\$ 140.00	\$ 42,000.00	\$ 87.00	\$ 26,100.00
20	4" Concrete Sidewalk (FDOT Index 310)	173	SY	\$ 67.17	\$ 29.73	\$ 47.00	\$ 8,131.00	\$ 75.00	\$ 12,975.00	\$ 48.00	\$ 8,304.00
21	SFWMD Bank Stabilization	1	LS	\$ 44,191.33	\$ 15,000.00	\$ 25,322.00	\$ 25,322.00	\$ 35,900.00	\$ 35,900.00	\$ 19,500.00	\$ 19,500.00
22	Information kiosk & Bicycle Rack	1	LS	\$ 12,081.67	\$ 20,000.00	\$ 10,875.00	\$ 10,875.00	\$ 4,500.00	\$ 4,500.00	\$ 11,000.00	\$ 11,000.00
23	24" Diameter RCP Yard Drain	1	EA	\$ 4,526.67	\$ 500.00	\$ 2,100.00	\$ 2,100.00	\$ 2,000.00	\$ 2,000.00	\$ 4,200.00	\$ 4,200.00
24	Reinforced Concrete Pipe Culvert (18")	16	LF	\$ 1,383.83	\$ 50.00	\$ 63.00	\$ 1,008.00	\$ 100.00	\$ 1,600.00	\$ 255.00	\$ 4,080.00
25	Single Post Sign	7	EA	\$ 482.33	\$ 250.00	\$ 446.00	\$ 3,122.00	\$ 350.00	\$ 2,450.00	\$ 490.00	\$ 3,430.00
26	12" Wide Solid White Stripe, Thermoplastic	48	LF	\$ 24.28	\$ 8.00	\$ 11.00	\$ 528.00	\$ 50.00	\$ 2,400.00	\$ 12.50	\$ 600.00
27	Pavement Marking, White, Thermoplastic, Yield Lines	3	EA	\$ 709.67	\$ 500.00	\$ 378.00	\$ 1,134.00	\$ 1,000.00	\$ 3,000.00	\$ 415.00	\$ 1,245.00
<b>TOTAL BID AMOUNT</b>						<b>\$ 811,585.00</b>		<b>\$ 946,193.00</b>		<b>\$ 972,146.00</b>	

CANAL POINT PEDESTRIAN BRIDGE

PBC PROJECT #2013601

				AVERAGE OF BID ITEMS	ENGINEERS ESTIMATE	FERREIRA CONSTRUCTION SOUTHERN DIVISION CO., INC.		CLOSE CONSTRUCTION, LLC		DRAWDY CONSTRUCTION CO., INC.	
ITEM #	DESCRIPTION	QTY	UNIT	UNIT PRICE	UNIT PRICE	UNIT PRICE	TOTAL	UNIT PRICE	TOTAL	UNIT PRICE	TOTAL
<b>REGULAR PAY ITEMS</b>											
1	Mobilization	1	LS	\$ 130,421.33	\$ 50,000.00	\$ 182,500.00	\$ 182,500.00	\$ 132,728.00	\$ 132,728.00	\$ 80,000.00	\$ 80,000.00
2	Maintenance of Traffic (MOT)	1	LS	\$ 66,775.00	\$ 3,000.00	\$ 33,500.00	\$ 33,500.00	\$ 7,500.00	\$ 7,500.00	\$ 300,000.00	\$ 300,000.00
3	Clearing and Grubbing	1	LS	\$ 7,646.67	\$ 10,000.00	\$ 5,640.00	\$ 5,640.00	\$ 7,100.00	\$ 7,100.00	\$ 5,000.00	\$ 5,000.00
4	Earthwork	1	LS	\$ 14,670.83	\$ 15,000.00	\$ 10,125.00	\$ 10,125.00	\$ 8,500.00	\$ 8,500.00	\$ 8,500.00	\$ 8,500.00
5	Cabbage Palmetto / Sabal Palmetto	18	EA	\$ 730.17	\$ 190.00	\$ 440.00	\$ 7,920.00	\$ 500.00	\$ 9,000.00	\$ 2,300.00	\$ 41,400.00
6	Mini Pine Nugget Mulch	6	CY	\$ 177.33	\$ 85.00	\$ 90.00	\$ 540.00	\$ 125.00	\$ 750.00	\$ 600.00	\$ 3,600.00
7	Bahia Sod	9,600	SF	\$ 0.82	\$ 0.20	\$ 0.55	\$ 5,280.00	\$ 1.00	\$ 9,600.00	\$ 1.50	\$ 14,400.00
8	Sidewalk Ramp Wall	38	CY	\$ 861.67	\$ 791.00	\$ 540.00	\$ 20,520.00	\$ 1,000.00	\$ 38,000.00	\$ 600.00	\$ 22,800.00
9	6" Thick Class II Concrete Deck	134	SY	\$ 124.00	\$ 85.00	\$ 120.00	\$ 16,080.00	\$ 55.00	\$ 7,370.00	\$ 80.00	\$ 10,720.00
10	Class IV Concrete (Substructure)	11	CY	\$ 1,617.67	\$ 1,141.00	\$ 2,545.00	\$ 27,995.00	\$ 800.00	\$ 8,800.00	\$ 1,400.00	\$ 15,400.00
11	Reinforcing Steel - Substructure	2,329	LB	\$ 2.17	\$ 0.85	\$ 1.50	\$ 3,493.50	\$ 3.00	\$ 6,987.00	\$ 3.00	\$ 6,987.00
12	Reinforcing Steel - Sidewalk ramp	8,545	LB	\$ 2.01	\$ 0.85	\$ 1.35	\$ 11,535.75	\$ 2.00	\$ 17,090.00	\$ 3.00	\$ 25,635.00
13	14" Pre-Stressed Piles	186	LF	\$ 253.67	\$ 75.00	\$ 405.00	\$ 75,330.00	\$ 374.00	\$ 69,564.00	\$ 200.00	\$ 37,200.00
14	18" Pre-Stressed Piles	163	LF	\$ 413.00	\$ 81.62	\$ 1,025.00	\$ 167,075.00	\$ 485.00	\$ 79,055.00	\$ 200.00	\$ 32,600.00
15	14" Pre-Stressed Test Piles with PDA	92	LF	\$ 531.33	\$ 125.00	\$ 495.00	\$ 45,540.00	\$ 1,375.00	\$ 126,500.00	\$ 400.00	\$ 36,800.00
16	18" Pre-Stressed Test Piles with PDA	194	LF	\$ 644.17	\$ 158.88	\$ 865.00	\$ 167,810.00	\$ 1,435.00	\$ 278,390.00	\$ 400.00	\$ 77,600.00
17	Pedestrian Bridge	1	LS	\$ 368,019.50	\$ 300,000.00	\$ 321,350.00	\$ 321,350.00	\$ 429,050.00	\$ 429,050.00	\$ 420,000.00	\$ 420,000.00
18	Guiderail (FDOT Index 880)	155	LF	\$ 72.83	\$ 50.00	\$ 60.00	\$ 9,300.00	\$ 68.00	\$ 10,540.00	\$ 85.00	\$ 13,175.00
19	Railing (FDOT Index 861)	300	LF	\$ 100.33	\$ 138.23	\$ 95.00	\$ 28,500.00	\$ 74.00	\$ 22,200.00	\$ 170.00	\$ 51,000.00
20	4" Concrete Sidewalk (FDOT Index 310)	173	SY	\$ 67.17	\$ 29.73	\$ 95.00	\$ 16,435.00	\$ 68.00	\$ 11,764.00	\$ 70.00	\$ 12,110.00
21	SFWMD Bank Stabilization	1	LS	\$ 44,191.33	\$ 15,000.00	\$ 64,710.00	\$ 64,710.00	\$ 74,716.00	\$ 74,716.00	\$ 45,000.00	\$ 45,000.00
22	Information kiosk & Bicycle Rack	1	LS	\$ 12,081.67	\$ 20,000.00	\$ 9,145.00	\$ 9,145.00	\$ 10,970.00	\$ 10,970.00	\$ 26,000.00	\$ 26,000.00
23	24" Diameter RCP Yard Drain	1	EA	\$ 4,526.67	\$ 500.00	\$ 3,860.00	\$ 3,860.00	\$ 3,000.00	\$ 3,000.00	\$ 12,000.00	\$ 12,000.00
24	Reinforced Concrete Pipe Culvert (18")	16	LF	\$ 1,383.83	\$ 50.00	\$ 185.00	\$ 2,960.00	\$ 200.00	\$ 3,200.00	\$ 7,500.00	\$ 120,000.00
25	Single Post Sign	7	EA	\$ 482.33	\$ 250.00	\$ 208.00	\$ 1,456.00	\$ 200.00	\$ 1,400.00	\$ 1,200.00	\$ 8,400.00
26	12" Wide Solid White Stripe, Thermoplastic	48	LF	\$ 24.28	\$ 8.00	\$ 14.20	\$ 681.60	\$ 10.00	\$ 480.00	\$ 48.00	\$ 2,304.00
27	Pavement Marking, White, Thermoplastic, Yield Lines	3	EA	\$ 709.67	\$ 500.00	\$ 115.00	\$ 345.00	\$ 150.00	\$ 450.00	\$ 2,200.00	\$ 6,600.00
<b>TOTAL BID AMOUNT</b>						<b>\$ 1,239,626.85</b>		<b>\$ 1,374,704.00</b>		<b>\$ 1,435,231.00</b>	

MATH ERROR ON ITEM #8

**CANAL POINT PEDESTRIAN BRIDGE  
PBC PROJECT #2013601**

*THE ITEMS AND QUANTITIES SHOWN, SHALL GOVERN OVER THE PLANS.  
PAY ITEM FOOTNOTES IN CONSTRUCTION PLANS SHALL ALSO BE INCLUDED IN ITEM UNIT PRICE.*

<b>PAY ITEM FOOTNOTES:</b>
<b>THE COUNTY DOES NOT GUARANTEE THE ACCURACY OF THE FORMULAS AND EXTENSIONS USED IN THIS SPREADSHEET.</b>
<b>THE ITEMS AND QUANTITIES ABOVE, SHALL GOVERN OVER THE PLANS.</b>
<b>PAY ITEM FOOTNOTES IN CONSTRUCTION PLANS SHALL ALSO BE INCLUDED IN ITEM UNIT PRICE.</b>
Mobilization consists of work and operations necessary to begin work on a project. Includes moving in equipment and personnel, establishing temporary offices, safety equipment and sanitary facilities. May include surveying, bond and insurance expenses. In some cases, may consist of security services and/or expenses associated with night work.
Maintenance of Traffic shall include all items required to safely maintain traffic throughout a transportation work zone with minimal inconvenience to the public.
Refer to Plans Preparation Manual, Volume 1, Chapter 3 for guidance on Earthwork Items.
All costs for complying with federal requirements shall be considered incidental to, and shall be included in, unit prices for the pay items.
Clearing and Grubbing Specifications for various processes required under clearing and grubbing item including tree removal.
All tree removal items shall include all costs associated with tree removal including MOT (if required), reduction of canopy, felling of trunk, stump removal, debris disposal and backfilling of hole with suitable material to provide a uniform grade.
All construction activities shall take place within and from the SFWMD rights-of-way
No separate payments made for deck scuppers, poured expansion joints, deck control joints, preformed anchor bolt holes, plain neoprene bearing pads. These items are included in the cost of concrete for all items where concrete is a component.
Shop drawings required for reinforcing items
Design quantity computed as the total anticipated length of pile without allowances for cutoffs, splices, dynamic load tests, or preforming. Construction final quantity will be adjusted based on allowances per the specifications. Per specification, "No payment will be made for dynamic load tests used to evaluate the integrity of a pre-planned epoxy-bonded dowel splice. Include all costs associated with dynamically testing production pile with epoxy-bonded dowel splices in the pay item.
Pre stressed piles include the cost and installation of the prestressed concrete test piling. Includes the payment for coordinating dynamic load test on test piles, The plan quantity (bid quantity, as listed in the summary of Pay Items) is computed as the total anticipated length of pile, without allowances for cutoffs splices or preforming. Final quantities will be adjusted according to specification allowances.
Prefabricated steel truss pedestrian bridge shall be paid for at the contract unit price as a lump sum for the entire structure with its installation components. This pay item includes furnishing and installing the prefabricated steel truss pedestrian bridge superstructure, including steel trusses, flow system, deck, bearing assemblies, deck joints, and bridge railing/fencing.
Payment for incidental items not specifically covered in the individual pay items shall be included in the contract unit price for the pay items.

*Working days to complete project: 150 calendar days (See Special Provisions)  
Bids as read at opening on Tuesday, April 19, 2016; 2:00 PM  
All bids subject to OSBA SBE compliance and Board Approval.  
Prepared by: Donna Lewis  
Checked by: Holly B. Knight, P.E., Contracts Section Manager*



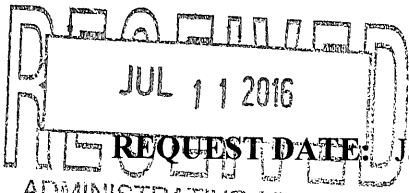

**BUDGET AVAILABILITY STATEMENT**

**ATTACHMENT 5**

**REQUEST DATE:** January 04, 2016

ADMINISTRATIVE SERVICES

**REQUESTED BY:** Alice Kovalainen

**PHONE:** 561 684 4043

**PROJECT TITLE:** Canal Point Pedestrian Bridge over L-10 canal

**PROJECT NO.:** 2013601

**LOCATION:** L-10 Canal

**LOCATION DESCRIPTION:** L-10 Canal Improvement (Pedestrian Bridge)

**CONTRACTOR/CONSULTANT NAME:** West Construction, INC.

**PROVIDE A BRIEF STATEMENT OF THE SCOPE OF SERVICES TO BE PROVIDED BY THE CONSULTANT/CONTRACTOR:** Construction cost for bridge

**WILL THIS AMENDMENT CHANGE THE ESTIMATED COST OF THE PROJECT? No. IF YES, PROVIDE ESTIMATES OF THE NEW COSTS:**

<b>CONSTRUCTION (local funding)</b>	<b>\$270,382</b>
<b>PROFESSIONAL SERVICES-Consultant</b>	
<b>STAFF COSTS** (Design/Construction Phase)</b>	
<b>MISC. (permits, prints, advertising, etcetera)</b>	
<b>TOTAL</b>	<b>\$270,382</b>

**NOTE:** The Office of Community Revitalization (OCR) is obligated to fund the Local funding amount of \$270,382

*\*By signing this BAS your department agrees to these staff costs and your account will be charged upon receipt of this BAS by OCR. Unless there is a change in the scope of work, no additional staff charges will be billed.*

**BUDGET ACCOUNT NUMBERS (IDENTIFY ALL SOURCES) FUNDING SOURCE (CHECK ALL THAT APPLY)**

**FUND:** 3900      **DEPT:** 366      **UNIT:** X168      **OBJ:** 6551      **SUBOBJ:**

**AD VALOREM**       **OTHER / GRANT(S)**       **FEDERAL/DAVIS BACON**

**If Grant(s), specify name of Grant(s):** FPN 433169-1-58-01  
Canal Point Pedestrian Bridge over L-10 canal

**SUBJECT TO INSPECTOR GENERAL FEE**       **YES**       **NO**

**BAS APPROVED BY** *[Signature]*      **DATE:** 07/07/2016

**ENCUMBRANCE NUMBER:** \_\_\_\_\_

2016

BOARD OF COUNTY COMMISSIONERS  
PALM BEACH COUNTY, FLORIDA  
BUDGET TRANSFER

Page 1 of 1 pages  
BGEX 366 071116\*1611

FUND 3900 Capital Outlay Fund

ATTACHMENT 6

ACCT.NUMBER	ACCOUNT NAME	ORIGINAL BUDGET	CURRENT BUDGET	INCREASE	DECREASE	ADJUSTED BUDGET	EXPENDED/ ENCUMBERED AS OF 07/11/2016	REMAINING BALANCE
<b><u>EXPENDITURES</u></b>								
366-X006-9909	Res-Improvement Progrm	349,393	251,922		66,827	185,095	0	185,095
366-X168-6551	Design/Eng/Mgmt- Cip Admin	0	898,306	66,827		965,133	393	964,740
<b>Total Appropriations &amp; Expenditures</b>				66,827	66,827			

Office of Community Revitalization  
INITIATING DEPARTMENT/DIVISION  
Administration/Budget Department Approval  
OFMB Department - Posted

Signatures

Date

By Board of County Commissioners  
At Meeting of

*Paul Skyring*  
\_\_\_\_\_

07/13/2016  
\_\_\_\_\_

\_\_\_\_\_  
Deputy Clerk to the  
Board of County Commissioners