

**PALM BEACH COUNTY
BOARD OF COUNTY COMMISSIONERS
AGENDA ITEM SUMMARY**

Meeting Date:	January 14, 2025	<input checked="" type="checkbox"/> Consent	<input type="checkbox"/> Regular
		<input type="checkbox"/> Ordinance	<input type="checkbox"/> Public Hearing
Department:	Engineering & Public Works		
Submitted By:	Engineering & Public Works		
Submitted For:	Traffic Division		

I. EXECUTIVE BRIEF

Motion and Title: Staff recommends motion to approve: the Fiscal Year 2025 sidewalk program.

SUMMARY: Approval of the program will allow for the scheduling and construction of the proposed projects that have been compiled in response to requests and input from the Palm Beach County (County) Office of Community Revitalization, Palm Tran, Municipalities, the Palm Beach County Sheriff's Office, the School District of Palm Beach County, and residents of the County. The proposed projects include nine (9) new construction projects and six (6) major maintenance projects. The total program cost is \$1,500,000 and is allocated among the following categories:



Major Maintenance	\$500,000
Non-School Related (New Construction)	\$837,340
School Related (New Construction)	\$30,400
Minor Maintenance & Support	\$132,260
Total	\$1,500,000

The sidewalk program supports areas without sidewalks that are not covered by our 5-Year Road Program, as some 5-Year Road Program major improvement projects do include sidewalk enhancements. The proposed list of projects for the program was previously sent to the Board of County Commissioners (BCC) for preliminary review by interoffice memorandum on November 21, 2024. Countywide (YBH)

Background and Justification: The purpose of the program is to provide a system of safe pedestrian sidewalks within the County. The Engineering and Public Works Department recommends BCC approval.

Attachments:

1. Location Maps
2. Proposed Project List

Recommended By:		
YBH/TEL	County Engineer	18 DEC 2024 Date
Approved By:		1/2/25 Date
	Deputy County Administrator	

**REQUEST FOR BUDGET AVAILABILITY STATEMENT
TRAFFIC DIVISION COSTS IN SUPPORT OF A
CONSTRUCTION CONTRACT AWARD**

TO: Kenny Rampersad
Director – Administrative Services

REQUEST DATE: November 22, 2024
PROJECT TITLE: PBC SIDEWALK PROGRAM
PROJECT LOCATION: Countywide
BOARD MEETING DATE: January 14, 2025

ESTIMATE OF COSTS: \$1,500,000

DESCRIPTION: FY 2025 Sidewalk Program

Contractor:
Wynn and Sons Environmental Construction Co. Inc.

BUDGET ACCOUNT NUMBER (IF KNOWN):

FUND	DEPT.	UNIT	OBJECT
3500	361		4612/6505/6551

BAS REQUESTED BY: 
Motasem Al-Turk, Ph.D., P.E.
Director - Traffic Division

MA/cmw

File: FY 2025 Sidewalk Program



Sidewalk
N&W Sides / 310' / Concrete
& Tie-Ins
\$51,100



Project Location:
— Missing sidewalk
⊕ Missing tie-in

District 4
Atlas 130



FY 2025 SIDEWALK PROGRAM

Boca Chica Lane Location Map

11-4-24



Brian Way
From Belvedere Rd
North to Existing
W Side / 730' / Concrete
\$91,900

— Project Location

District 2
Atlas 69



FY 2025 SIDEWALK PROGRAM

Brian Way
Location Map

11-4-24



Communitywide Tie-Ins
\$86,650

Project Location:
Missing tie-in

District 5
Atlas 119



FY 2025 SIDEWALK PROGRAM

Country Landing Two
Location Map

11-4-24

N:\TRAFFIC\Board\2025 Board items\1-14-25\FY 2025 Sidewalk Program\Figures 11-4-2024\4 Country Landing 2 LM.doc



Edisto Dr
From Summerville Ter
to Playground
N Side / 455' / Concrete
\$41,000

Smith Farm
Blvd

FL
Turnpike ←



Project Location

District 2
Atlas 96



FY 2025 SIDEWALK PROGRAM

Edisto Drive at Summerville Terrace
Location Map

11-4-24



Sidewalk
N & S Sides / 165' / Concrete

Gramercy Park East
Communitywide
Tie-Ins (56)
\$98,190



Project Location:
Missing sidewalk
Missing tie-in

District 7
Atlas 46



FY 2025 SIDEWALK PROGRAM

Gramercy Park East Location Map

11-4-24



Hypoluxo Rd
 from NW 7 Ct
 to High Ridge Rd
 S Side / 360' / Concrete
 \$96,900 (ROW acq)

High Ridge Rd
 from Imagine-Chancellor
 to Hypoluxo Rd
 W Side / 3,460' / Asphalt / Concrete
 \$173,800 (ROW acq)

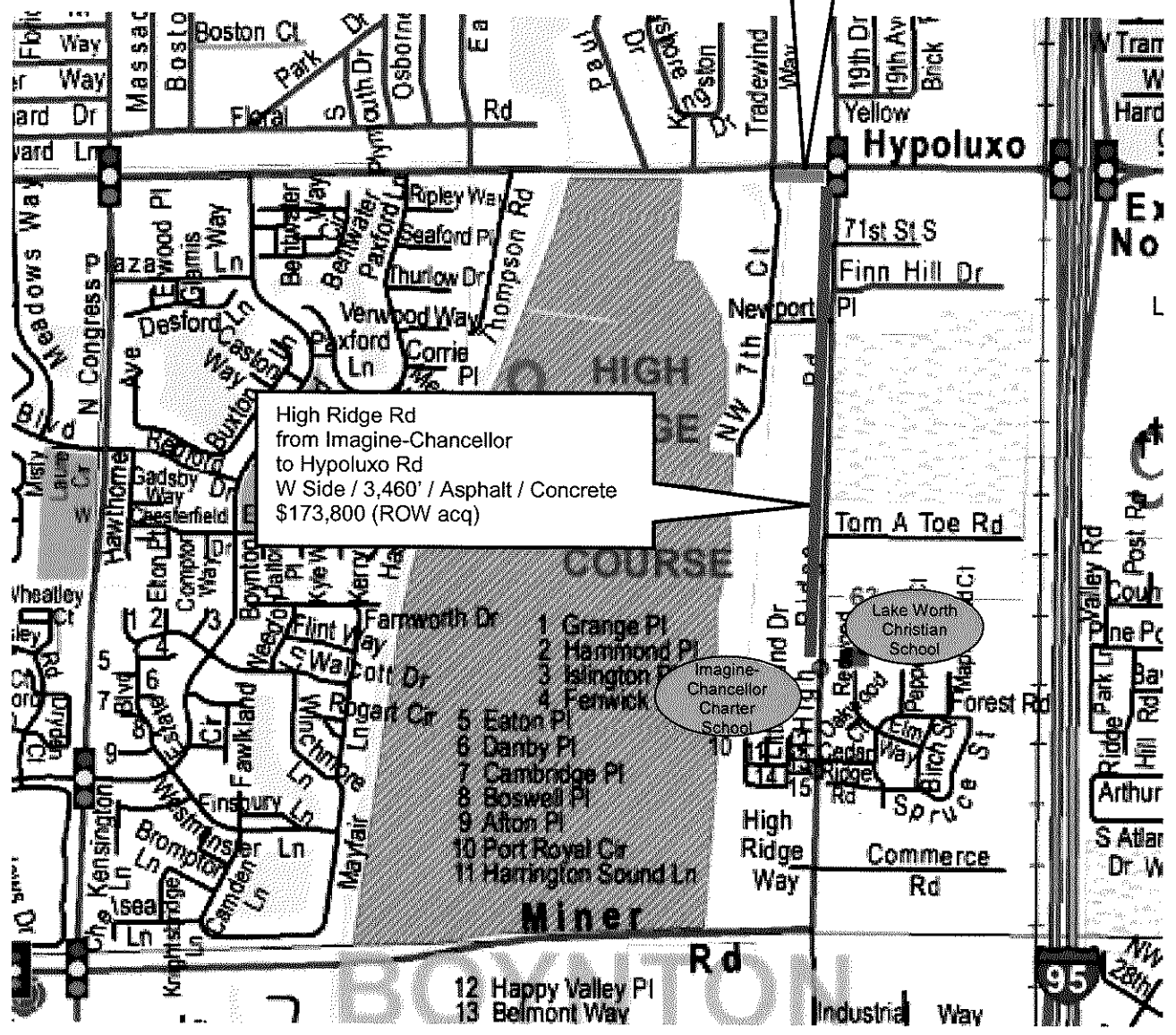

Project Location:
 Hypoluxo Road
 High Ridge Road

District 2
 Atlas 99



FY 2025 SIDEWALK PROGRAM

High Ridge Road & Hypoluxo Road
 Location Map

11-4-24

N:\TRAFFIC\Board\2025 Board items\11-4-25\FY 2025 Sidewalk Program\Figures 11-4-2024\7 High Ridge + Hypoluxo LM.doc

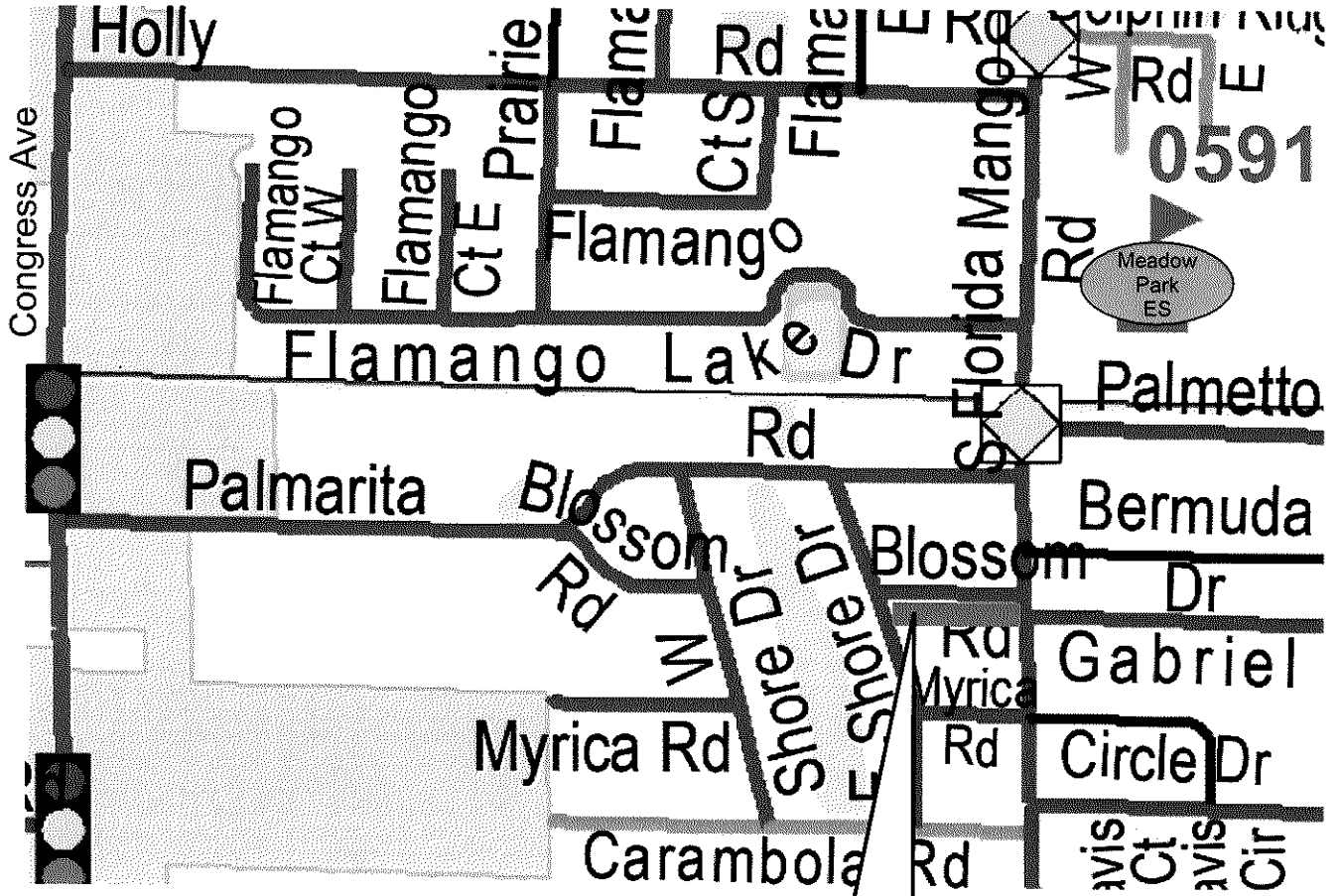

Blossom Rd
from E Shore Dr
to Florida Mango Rd
S Side / 360' / Asphalt
\$30,400

Project Location

District 3
Atlas 71



FY 2025 SIDEWALK PROGRAM

Blossom Road
Location Map

11-4-24

N:\TRAFFIC\Board\2025 Board Items\1-14-25\FY 2025 Sidewalk Program\Figures 11-4-2024\8 Blossom LM.doc

**FY 2025 SIDEWALK PROGRAM
PROPOSED PROJECT LIST**

ATTACHMENT 1 PAGE #	PROJECT LOCATION	FROM > TO	ROAD SIDE	COMM DISTRICT	ESTIMATED COST	LENGTH (LF)	SIDEWALK TYPE	WIDTH (FT)	ATLAS PAGE	REQUESTED BY
MAJOR MAINTENANCE										
NA	64 DRIVE N	DONALD ROSS RD TO 143 ST N	E	1	13,440	1,500	ASPHALT	6	14	ROAD & BRIDGE
NA	69 DRIVE N	DONALD ROSS RD TO 155 PL N	W	1	76,160	8,250	ASPHALT	6	14	ROAD & BRIDGE
NA	143 STREET N	69 DR N TO 64 DR N	N	1	22,400	2,400	ASPHALT	6	14	ROAD & BRIDGE
NA	EL CLAIR RANCH RD	L-29 CANAL TO L-28 CANAL (N&S OF PIPERS GLEN BLVD)	E	5	34,400	2,700	ASPHALT	9	103	ROAD & BRIDGE
NA	NICKELS BLVD	OLD BOYNTON RD TO GENEVRA AVE	W	2	52,600	2,500	ASPHALT	6	98	ROAD & BRIDGE
NA	SHOREWIND DR	CORNER LN EAST TO PALMETTO PARK RD	E/N/W	5	301,000	5,280	ASPHALT	9	127	ROAD & BRIDGE
SUBTOTAL					500,000					
NON-SCHOOL RELATED - NEW CONSTRUCTION										
1	BOCA CHICA LN	MISSING SIDEWALK & TIE-INS	N&W	4	51,100	310	CONCRETE	6	130	RESIDENT
2	BOCA RIO RD	SW 8 ST TO HABCENTER	W	5	197,800	1,805	CONCRETE	6	129	PALM TRAN
3	BRIAN WAY	BELVEDERE RD NORTH TO EXISTING	W	2	91,900	730	CONCRETE	6	69	OCR / RES
4	COUNTRY LANDING TWO	COMMUNITYWIDE TIE-INS (34)		5	86,650		CONCRETE	6	119	RESIDENT
5	EDISTO DR	SUMMERVILLE TER TO PLAYGROUND	N	2	41,000	455	CONCRETE	6	96	RESIDENT
6	GRAMERCY PARK EAST	MISSING SIDEWALK & TIE-INS (56)	N&S	7	98,190	165	CONCRETE	6	46	OCR / RES
7	HIGH RIDGE RD	IMAGINE-CHANCELLOR TO HYPOLUXO RD	W	2	173,800	3,460	CON/ASPH	6 / 5	99	CITY
7	HYPOLUXO RD	NW 7 CT TO HIGH RIDGE RD	S	2	96,900	360	CONCRETE	6	99	RESIDENT
SUBTOTAL					837,340					
SCHOOL RELATED - NEW CONSTRUCTION										
8	BLOSSOM RD	E SHORE DR TO FLORIDA MANGO RD	S	3	30,400	360	ASPHALT	6	71	RESIDENT
SUBTOTAL					30,400					
MINOR MAINTENANCE AND SUPPORT										
SUBTOTAL					132,260					
TOTAL					\$ 1,500,000					

OCR = OFFICE OF COMMUNITY REVITALIZATION
CITY = CITY OF BOYNTON BEACH