

PALM BEACH COUNTY
BOARD OF COUNTY COMMISSIONERS

AGENDA ITEM SUMMARY

Meeting Date: February 11, 2025 Consent [X] Regular []
Public Hearing []

Department: Water Utilities Department

I. EXECUTIVE BRIEF

Motion and Title: Staff recommends motion to approve: Supplement No. 3 to Consultant Services Authorization No. 3 (CSA 3) to the Consulting/Professional Services System-Wide Wellfield Improvements Hydrogeologic Engineering Design and Construction Services (Contract) with JLA Geosciences, Inc. (Consultant), for the System-Wide Wellfield Improvement Phase 2 Construction Phase Services for a not to exceed amount of \$403,585.46.

Summary: On April 2, 2019, the Board of County Commissioners (BCC) approved the Palm Beach County Water Utilities Department (PBCWUD) Contract (R2019-0439) with the Consultant. CSA 3 Supplement No. 3 provides for additional construction phase services for nine (9) months for PBCWUD Water Treatment Plant Nos. 2 and 8. This supplement aligns the construction phase services with the current construction duration of the Wellfield Improvements Phase 2 (Project) for which the Consultant oversees. The anticipated completion date for the Project is April 2025. The Consultant will provide additional project management, construction oversight and review requests for additional information and change orders for the additional time duration requested.

The Contract was procured under the requirements for the 2002 Small Business Enterprise (SBE) Ordinance (R2002-0064) prior to the adoption of the new Equal Business Opportunity (EBO) Ordinance on October 16, 2018. The SBE participation goal under the 2002 Ordinance was 15% overall participation. The proposed SBE participation for this CSA 3 Supplement No. 3 is 75.34%. To date, the overall participation achieved on this project is 78.69%. The Consultant is a Palm Beach County based company. The Project is included in the PBCWUD FY 2025 budget (PBCWUD Project 19-022) District 2 (MWJ)

Background and Justification: PBCWUD is committed to the proactive rehabilitation in order to increase overall production well efficiency and reliability, as well as reduce energy consumption. Completion of the work provided for in the Project will provide for the work necessary to rehabilitate the wellfields for Water Treatment Plant Nos. 2 and 8. CSA 3 Supplement No. 3 will provide for an extension of the construction management services and field oversight needed for the rehabilitation of the surficial aquifer production wells.

Attachments:

- 1. Two (2) Originals of CSA 3 Supplement No. 3
- 2. Location Map
- 3. EBIX Compliance Summary Report

Recommended By: Al. Boat 1/19/25
Department Director Date

Approved By: Walter J. Blue 4/27/25
Assistant County Administrator Date

II. FISCAL IMPACT ANALYSIS

A. Five Year Summary of Fiscal Impact:

Fiscal Years	2025	2026	2027	2028	2029			
Capital Expenditures	\$403,586	0	0	0	0			
Operating Costs	0	0	0	0	0			
External Revenues	0	0	0	0	0			
Program Income (County)	0	0	0	0	0			
In-Kind Match County	0	0	0	0	0			
NET FISCAL IMPACT	\$403,586	0	0	0	0			
# ADDITIONAL FTE POSITIONS (Cumulative)	0	0	0	0	0			
Budget Account No.:	Fund	4011	Dept	721	Unit	W004	Object	6541

Is Item Included in Current Budget? Yes X No

Is this item using Federal Funds? Yes No X

Is this item using State Funds? Yes No X

Reporting Category N/A

B. Recommended Sources of Funds/Summary of Fiscal Impact:

One (1) time expenditure from user fees, connection fees and balance brought forward.

C. Department Fiscal Review: *Eric Egerton R-ER*

III. REVIEW COMMENTS

A. OFMB Fiscal and/or Contract Development and Control Comments:

Lisa Mante 1/16/2025
OFMB *PA 1/16*
NAF 1/16

Brenda Grackel 1/21/25
Contract Development and Control
267 1.17.25

B. Legal Sufficiency:

[Signature] 1/27/25
Assistant County Attorney

C. Other Department Review:

Department Director

SUPPLEMENT NO. 3
CONSULTANT SERVICES AUTHORIZATION NO. 3
Palm Beach County Water Utilities Department
Contract for Consulting/Professional Services
System-Wide Wellfield Improvements Hydrogeologic, Engineering Design and Construction Services
Resolution No. R2019-0439 Contract Dated April 2, 2019

Project Title: System-Wide Wellfield Improvements Phase 2 Construction Phase Services

PBCWUD Project No.: 19-022

Consultant: JLA Geosciences, Inc.

Address: 1907 Commerce Lane, Suite 104, Jupiter, Florida 33458

Budget Line Item No.: 4011-721-W004-6541

District No.: 2

This Supplement Consultant Services Authorization provides for: professional services to provide additional construction phase services for nine (9) months for Palm Beach County Water Utilities Department (PBCWUD) Water Treatment Plant Nos. 2 and 8, located in West Palm Beach, Florida.

(See ATTACHMENT A for detailed scope of services)

The Contract provides for 59.00% SBE participation, which includes 22.00% M/WBE participation, 1.00% MBE (B), 20.00% MBE (H), and 1.00% WBE. This Supplement Consultant Services Authorization includes 75.34% overall participation which includes, 16.27% M/WBE participation, 16.27% MBE (B), 0.00% MBE (H), and 0.00% WBE. The cumulative SBE participation, including this Supplement Consultant Services Authorization is 78.69% SBE, which includes 38.81% M/WBE participation, 3.07% MBE (B), 19.29% MBE (H), and 0.90% WBE.

1. Services completed by the Consultant to date :

See ATTACHMENT B.

2. Consultant shall begin work upon receipt of Notice to Proceed correspondence.
3. The compensation to be paid to the Consultant for providing the requested services shall be:
 - A. Computation of time charges plus expenses, not to exceed \$403,585.46
 - B. Fixed price of \$ 0.00
 - C. Total \$403,585.46
4. This Authorization may be terminated, in whole or in part, by the County with or without cause in accordance with the Contract terms. In the event of termination not the fault of the Consultant, the Consultant shall be compensated for all services performed to termination date, together with reimbursable expenses (if applicable) then due in accordance with the Contract terms. Consultant agrees to waive any and all claims for lost profits or anticipated future profits in the event of a termination with or without cause under this Contract.

SUPPLEMENT NO. 3
CONSULTANT SERVICES AUTHORIZATION NO. 3
Palm Beach County Water Utilities Department
Contract for Consulting/Professional Services
System-Wide Wellfield Improvements Hydrogeologic, Engineering Design and Construction Services
Resolution No. R2019-0439 Contract Dated April 2, 2019

Project Title: System-Wide Wellfield Improvements Phase 2 Construction Phase Services

PBCWUD Project No.: 19-022

5. SBE participation is included in **ATTACHMENT C** under this Authorization. The attached Schedule 1 defines the SBE applied to this Authorization and Schedule 2 establishes the SBE contribution from each Sub-Consultant (Letter of Intent).
6. This Authorization does not amend, change, or modify the Contract dated April 2, 2019 which remains in full force and effect.
7. All Attachments to this Authorization are incorporated herein and made a part of this Consultant Services Authorization.

SUPPLEMENT NO. 3
CONSULTANT SERVICES AUTHORIZATION NO. 3
Palm Beach County Water Utilities Department
Contract for Consulting/Professional Services
System-Wide Wellfield Improvements Hydrogeologic, Engineering Design and Construction Services
Resolution No. R2019-0439 Contract Dated April 2, 2019

Project Title: System-Wide Wellfield Improvements Phase 2 Construction Phase Services

PBCWUD Project No.: 19-022

IN WITNESS WHEREOF, this Authorization is accepted, subject to the terms, conditions and obligations of the aforementioned Contract.

PALM BEACH COUNTY, A POLITICAL SUBDIVISION OF THE STATE OF FLORIDA

Joseph Abruzzo, Clerk of the Circuit Court
& Comptroller, Palm Beach County

Palm Beach County, Board
of County Commissioners

ATTEST:

Signed: _____

Signed: _____ *NPG*

Typed Name: _____
Deputy Clerk

M3
Maria G. Marino, Mayor

(Date)

Approved as to Form and Legal
Sufficiency

JLA Geosciences, Inc.
(Consultant)

Signed: _____

James L. Andersen
(Print Name)

Typed Name: Michael W. Jones
County Attorney

[Signature]
(Signature)
Principal

(Title)
11/20/2024
(Date)

STATE OF FLORIDA
COUNTY OF Palm Beach

The foregoing instrument was acknowledged before me by means of physical presence or online notarization, this 20th day of November, 2024, by James L. Andersen who is personally known to me or has produced _____ as identification.

[Signature]
(Signature of Notary Public - State of Florida)

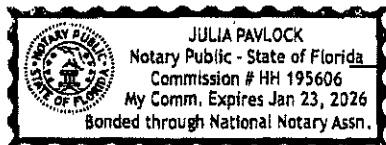

(Print, Type, or Stamp Commissioned Name of Notary Public)

SUPPLEMENT NO. 3
CONSULTANT SERVICES AUTHORIZATION NO. 3
Palm Beach County Water Utilities Department
Contract for Consulting/Professional Services
System-Wide Wellfield Improvements Hydrogeologic, Engineering Design and Construction Services
Resolution No. R2019-0439 Contract Dated April 2, 2019

LIST OF ATTACHMENTS

ATTACHMENT A	Scope of Services
ATTACHMENT B	Summary and Status of Consultant Services Authorizations
ATTACHMENT C	OEBO Schedules 1 and 2
ATTACHMENT D	Project Schedule
ATTACHMENT E	Budget Summary
ATTACHMENT F	Summary of SBE-M/WBE Business Tracking
ATTACHMENT G	Location Map

Revised 06-12-24

ATTACHMENT A

SCOPE OF SERVICES

PBCWUD Project No.: 19-022

Project Title: System-Wide Wellfield Improvements Phase 2 Construction Phase Services

BACKGROUND

Palm Beach County Water Utilities Department (PBCWUD) subcontracted JLA Geosciences, Inc. (CONSULTANT) to perform oversight for construction phase services associated with PBCWUD Project Number (No.) WUD 19-022, System-Wide Wellfield Improvements Phase 2. The original duration for Consultant Services Authorization (CSA) No. 3 was approved on December 21, 2021, for an anticipated 30-month period. Subsequently, CSA No. 3, Supplement No. 2 extended the construction phase services an additional 21 days. Based on the current schedule provided by the awarded contractor, Florida Design Drilling LLC, the anticipated project completion date is now April 2025, requiring an additional nine (9) months of construction phase services. This CSA supplement outlines the scope of work associated with these additional services.

Additionally, this CSA supplement includes a request to substitute the subconsultant Engineered Design Services LLC (EDS). Initially, EDS was approved under CSA No. 3 to provide engineering construction phase services as outlined in Task 1.7.1. However, as detailed in EDS's letter dated February 12, 2024 (included as Attachment H), they are no longer able to fulfill the outlined scope. The CONSULTANT is requesting approval to replace EDS with Kimley-Horn and Associates, Inc. (KHA), an existing subconsultant engineering firm. KHA is qualified to perform the required scope of work and is also the Engineer of Record for this project.

A summary of the scope of work, manhours, and cost differences between the two subconsultants is presented below, with a detailed description provided in Task 1.7.1.

	Engineered Design Services LLC (June 2021)	Kimley-Horn and Associates, Inc. (January 2025)
SCOPE OF WORK	Concrete site inspection work for Water Treatment Plants 2 and 9	Concrete site inspection work for Water Treatment Plants 2 and 9
MANHOURS	184 hours	184 hours
TOTAL COST	(\$20,352.00)	\$24,337.72
COST DIFFERENCE	--	\$3,985.72

JLA Geosciences, Inc. (CONSULTANT) shall perform:

TASK 1.0 ADDITIONAL CONSTRUCTION PHASE SERVICES

The CONSULTANT shall provide additional project management and construction oversight associated with PBCWUD System-Wide Wellfield Improvements Phase 2 Construction Phase Services through project completion. Florida Design Drilling LLC, the awarded PBCWUD contractor, currently anticipates project completion in April 2025.

Revised 06-12-24

- Task 1.1 Additional Project Management (9 months estimated)** – The CONSULTANT shall provide project coordination with PBCWUD representatives and Construction Contractor and overall general project management during field services.
- Task 1.2 Preconstruction meeting** – Not Applicable.
- Task 1.3 Additional Progress Meetings (9 months estimated)** – The CONSULTANT shall prepare for and attend monthly progress meetings throughout the duration of the project (9 months) including summarized meeting minutes and agendas.
- Task 1.4 Additional Contractor submittal review (12 estimated)** – The CONSULTANT and its SUBCONSULTANTS shall review up to twelve (12) contractor submitted requests for additional information (RAIs) and contract change orders. The CONSULTANT and its SUBCONSULTANTS shall provide clarifications and interpretations of the Contract documents in response to the RAIs in a written format to the Contractor. The CONSULTANT shall review Contractor submitted change orders and provide recommendations to PBCWUD for approval or rejection.
- Task 1.5 Additional Payment Application Review (9 months estimated)** – The CONSULTANT and its SUBCONSULTANTS shall review and provide recommendations for the acceptance of the contractor-submitted payment applications (9 estimated).
- Task 1.6 Additional Daily Work Reports, Weekly Project Summary Updates (9 months estimated)** – The CONSULTANT and its SUBCONSULTANTS shall prepare daily work reports for site inspection activities and submit them to the PBCWUD on a weekly basis during well field construction activities.
- Task 1.7 Additional Field Construction Oversight (9 months estimated)** - The CONSULTANT and its SUBCONSULTANTS shall provide construction oversight, development, and testing during critical phases of construction including: casing installations, grouting, completion of interval drilling, well development, step drawdown testing, including performing water level measurements, specific capacity analysis and field water quality testing. This task will also include well construction field logs, water quality field data summaries, and copies of the geophysical logs provided by the Contractor. Digital photos will be taken of significant activities during well construction.
- The CONSULTANT and its SUBCONSULTANTS shall provide coordination and management of mechanical and electrical improvements, including field assistance during well start-up, pump test results and recommendations for permanent pump setting depth and in-service pumping rate.
- The CONSULTANT and its SUBCONSULTANTS shall prepare daily work reports for site inspection activities and submit them to the PBCWUD on a weekly basis during well field construction activities.
- The CONSULTANT shall provide an additional six (6) months of monthly vibration monitoring at each applicable well site during construction activities. Compliance with vibration standards shall remain the responsibility of the Contractor.
- Task 1.7.1 Phase 2 Field Construction Oversight (Previously under EDS)** - The CONSULTANT and its SUBCONSULTANTS will provide onsite construction observations for the concrete placements of the Well slabs. The CONSULTANT will review the concrete mix shop drawing for conformance with the project documents. The CONSULTANT will review concrete formwork, rehab and subgrade densities. The

CONSULTANT will review concrete pours, slump tests and concrete test cylinders. The CONSULTANT will provide a field summary report after each concrete placement.

Deliverables

- Electronic copies of monthly progress meeting agendas and minutes shall be submitted to PBCWUD in Portable Document Format (PDF).
- Electronic copies of monthly pay application reviews shall be submitted to PBCWUD in electronic mail (email) format.
- Contractor submitted RAIs and change order reviews shall be submitted to PBCWUD in email format.
- Weekly project summaries shall be to PBCWUD in email format.

Assumptions

- Assumptions shall be in accordance with the existing approved CSA No. 3.

ATTACHMENT B

SUMMARY AND STATUS OF CONSULTANT SERVICES AUTHORIZATIONS

Auth. No.	PBCWUD Project No.	Title	Status	Project Total Amount	SBE Total Amount	SBE Participation %	Approved	
							By	Date
1	19-022	System-Wide Wellfield Improvements, Design, Permitting and Bidding Services	Approved	\$1,208,727.59	\$ 745,711.63	61.69%	BCC	4/2/2019
1.1	19-022	System-Wide Wellfield Improvements, Design, Permitting and Bidding Services	Approved	\$96,394.62	\$ 92,035.88	95.47%	CRC	10/2/2019
1.2	19-022	System-Wide Wellfield Improvements, Design, Permitting and Bidding Services	Approved	\$57,513.55	\$ 39,503.55	68.68%	CRC	1/8/2020
1.3	19-022	System-Wide Wellfield Improvements, Design, Permitting and Bidding Services	Approved	\$6,302.99	\$ 6,302.99	100.00%	Director	4/9/2020
1.4	19-022	System-Wide Wellfield Improvements, Design, Permitting and Bidding Services	Approved	\$35,097.58	\$ 12,321.58	35.10%	Director	2/2/2021
1.5	19-022	System-Wide Wellfield Improvements, Design, Permitting and Bidding Services	Approved	\$15,801.00	\$ 7,890.00	49.93%	Director	11/16/2021
1.6	19-022	System-Wide Wellfield Improvements, Design, Permitting and Bidding Services	Approved	\$60,292.73	\$ 38,229.61	63.40%	CRC	8/31/2022
1.7	19-022	System-Wide Wellfield Improvements, Design, Permitting and Bidding Services	Pending	\$3,200.00	\$ 0.00	0.00%	Director	Pending
2	19-022	System-Wide Wellfield Improvements Phase 1 Construction Phase Services	Approved	\$1,761,713.50	\$ 1,646,729.50	93.47%	BCC	10/20/2020
2.1	19-022	System-Wide Wellfield Improvements Phase 1 Construction Phase Services	Approved	\$7,707.00	\$ 5,220.00	67.73%	Director	8/5/2024
3	19-022	System-Wide Wellfield Improvements Phase 2 Construction Phase Services	Approved	\$1,314,167.20	\$ 1,031,711.20	78.50%	BCC	12/21/2021
3.1	19-022	System-Wide Wellfield Improvements Phase 2 Construction Phase Services	Approved	\$17,561.00	\$ 17,561.00	100.00%	Director	9/18/2023
3.2	19-022	System-Wide Wellfield Improvements Phase 2 Construction Phase Services	Approved	\$57,287.10	\$ 27,917.94	48.73%	CRC	10/16/2024
3.3	19-022	System-Wide Wellfield Improvements Phase 2 Construction Phase Services	Pending	\$403,585.46	\$ 304,100.17	75.34%	BCC	Pending

ATTACHMENT C

OEBO SCHEDULE 1

Office of Equal Business Opportunity Compliance Programs

OEBO SCHEDULE 1

SOLICITATION/PROJECT/BID NAME: System-Wide Wellfield Improvements Phase 2 Construction Phase Services
 SOLICITATION OPENING/SUBMITTAL DATE: N/A

SOLICITATION/PROJECT/BID NO.: 19-022
 COUNTY DEPARTMENT: Water Utilities Department

Section A PLEASE LIST THE DOLLAR AMOUNT OR PERCENTAGE OF WORK TO BE COMPLETED BY THE PRIME CONTRACTOR/CONSULTANT* ON THE PROJECT:

NAME OF PRIME RESPONDENT/BIDDER: JLA Geosciences, Inc. ADDRESS: 1907 Commerce Lane, Suite 104, Jupiter Florida 33458

CONTACT PERSON: James L. Andersen, P.G. PHONE NO.: 561 746-0228 E-MAIL: JANDERSEN@JLAGEOSCIENCES.COM

PRIME'S DOLLAR AMOUNT OR PERCENTAGE OF WORK: \$238,425.02

*SMWBE Prime's must include their percentage or dollar amount in the Total Participation line under section B.

Non-SBE
 MBE
 WBE
 SBE

Section B PLEASE LIST THE DOLLAR AMOUNT OR PERCENTAGE OF WORK TO BE COMPLETED BY ALL SUBCONTRACTORS/SUBCONSULTANTS ON THE PROJECT BELOW:

Subcontractor/Sub consultant Name	(Check all Applicable Categories)				DOLLAR AMOUNT OR PERCENTAGE OF WORK					
	Non-SBE	MBE Minority Business	WBE Women Business	SBE Small Business	Black	Hispanic	Women	Caucasian	Asian	Other
	1. Electrical Design Associates, Inc.	<input type="checkbox"/>	<input checked="" type="checkbox"/>	<input type="checkbox"/>	<input checked="" type="checkbox"/>	\$86,027.15				
2. Kimley-Horn and Associates, Inc.	<input checked="" type="checkbox"/>	<input type="checkbox"/>	<input type="checkbox"/>	<input type="checkbox"/>						\$99,485.29
3. Engineered Design Services LLC	<input type="checkbox"/>	<input checked="" type="checkbox"/>	<input type="checkbox"/>	<input checked="" type="checkbox"/>	(\$20,352.00)					
4.	<input type="checkbox"/>	<input type="checkbox"/>	<input type="checkbox"/>	<input type="checkbox"/>						
5.	<input type="checkbox"/>	<input type="checkbox"/>	<input type="checkbox"/>	<input type="checkbox"/>						
Total					\$65,675.15					\$99,485.29

(Please use additional sheets if necessary)

Total Bid/Offer Price \$ \$403,585.46

Total Certified S/M/WBE Participation \$ \$304,100.17

I hereby certify that the above information is accurate to the best of my knowledge: James L. Andersen President, JLA Geosciences, Inc.
 Name & Authorized Signature _____ Title _____

- Note:**
- The amount listed on this form for a Subcontractor/sub consultant must be supported by price or percentage listed on the properly executed Schedule 2 or attached signed proposal.
 - Only those firms certified by Palm Beach County at the time of solicitation due date are eligible to meet the established OEBO Affirmative Procurement Initiative (API). Please check the applicable box and list the dollar amount or percentage under the appropriate demographic category.
 - Modification of this form is not permitted and will be rejected upon submittal.
 - If a Mandatory API goal applies, failure to submit a properly executed Schedule 2 will result in a determination of non-responsiveness to the solicitation.



If you have experienced or witnessed a violation of the EBO Ordinance or would like to file a complaint, please scan the QR Code

ATTACHMENT C

OEBO SCHEDULE 2

Office of Equal Business Opportunity Compliance Programs

Revised 06-12-24

OEBO LETTER OF INTENT – SCHEDULE 2

A completed Schedule 2 is a binding document between the Prime Contractor/consultant and a Subcontractor/subconsultant (for any tier) and should be treated as such. All Subcontractors/subconsultants, including any tiered Subcontractors/subconsultants, must properly execute this document. If a Mandatory API goal applies, failure to submit a properly executed Schedule 2 will result in a determination of non-responsiveness to the solicitation. Each properly executed Schedule 2 must be submitted with the bid/proposal.

SOLICITATION/PROJECT NUMBER: PBCWUD 19-022
 SOLICITATION/PROJECT NAME: System-Wide Wellfield Improvements Phase 2 Construction Phase Services

Prime Contractor: JLA Geosciences, Inc. Subcontractor: _____

(Check box(s) that apply)

SBE WBE MBE M/WBE Non-S/M/WBE Date of Palm Beach County Certification (if applicable): 4/10/23-4/9/26

The undersigned affirms they are the following (select one from each column if applicable):

Column 1	Column 2	Column 3
<input checked="" type="checkbox"/> Male <input type="checkbox"/> Female	<input type="checkbox"/> African-American/Black <input type="checkbox"/> Asian American <input checked="" type="checkbox"/> Caucasian American <input type="checkbox"/> Hispanic American <input type="checkbox"/> Native American	<input type="checkbox"/> Supplier

S/M/WBE PARTICIPATION – S/M/WBE Primes must document all work to be performed by their own work force on this form. Specify in detail, the scope of work to be performed or items supplied with the dollar amount and/or percentage for each work item. When applicable, identify the line item(s) associated with the service/product being supplied. S/M/WBE credit will only be given for the areas in which the S/M/WBE is certified. A detailed quote/proposal may be attached to a properly executed Schedule 2 for additional information.

Line Item	Item Description	Unit Price	Quantity/ Units	Contingencies/ Allowances	Total Price/Percentage
	Hydrogeologic Consulting	\$403,585.46	1		\$403,585.46
	Commodity Codes: 91843, 91855, 92683, 96143, 96892				

The undersigned Subcontractor/subconsultant is prepared to self-perform the above-described work in conjunction with the aforementioned project at the following total price or percentage: \$238,425.02

If the undersigned intends to subcontract any portion of this work to another Subcontractor/subconsultant, please list the business name and the amount below accompanied by a separate properly executed Schedule 2.

Electrical Design Associates, Inc., Kimley-Horn and Associates, Inc., Engineered Design Services LLC
 Name of 2nd/3rd tier Subcontractor/subconsultant _____ Price or Percentage: \$86,027.15, \$99,485.29, (\$20,352.00)

JLA Geosciences, Inc.
 Print Name of Prime
 By: _____
 Authorized Signature
James L. Andersen
 Print Name
President
 Title
 Date: 01/10/2025

JLA Geosciences, Inc.
 Print Name of Subcontractor/subconsultant
 By: _____
 Authorized Signature
James L. Andersen
 Print Name
President
 Title
 Date: 01/10/2025



If you have experienced or witnessed a violation of the EBO Ordinance or would like to file a complaint, please scan the QR Code

OEBO LETTER OF INTENT – SCHEDULE 2

A completed Schedule 2 is a binding document between the Prime Contractor/consultant and a Subcontractor/subconsultant (for any tier) and should be treated as such. All Subcontractors/subconsultants, including any tiered Subcontractors/subconsultants, must properly execute this document. If a Mandatory API goal applies, failure to submit a properly executed Schedule 2 will result in a determination of non-responsiveness to the solicitation. Each properly executed Schedule 2 must be submitted with the bid/proposal.

SOLICITATION/PROJECT NUMBER: PBCWUD 19-022

SOLICITATION/PROJECT NAME: System-Wide Wellfield Improvements Phase 2 Construction Phase Services

Prime Contractor: JLA Geosciences, Inc.

Subcontractor: Kimley-Horn and Associates, Inc.

(Check box(s) that apply)

SBE WBE MBE M/WBE Non-S/M/WBE

Date of Palm Beach County Certification (if applicable): N/A

The undersigned affirms they are the following (select one from each column if applicable):

Column 1

Column 2

Column 3

Male Female

African-American/Black Asian American Caucasian American

Supplier

Hispanic American Native American

S/M/WBE PARTICIPATION – S/M/WBE Primes must document all work to be performed by their own work force on this form. Specify in detail, the scope of work to be performed or items supplied with the dollar amount and/or percentage for each work item. When applicable, identify the line item(s) associated with the service/product being supplied. S/M/WBE credit will only be given for the areas in which the S/M/WBE is certified. A detailed quote/proposal may be attached to a properly executed Schedule 2 for additional information.

Line Item	Item Description	Unit Price	Quantity/ Units	Contingencies/ Allowances	Total Price/Percentage
	Engineering Consulting	\$99,485.29	1		\$99,485.29
	Commodity Codes: 92597, 92567, 92517				

The undersigned Subcontractor/subconsultant is prepared to self-perform the above-described work in conjunction with the aforementioned project at the following total price or percentage: \$99,485.29

If the undersigned intends to subcontract any portion of this work to another Subcontractor/subconsultant, please list the business name and the amount below accompanied by a separate properly executed Schedule 2.

N/A Price or Percentage: N/A

Name of 2nd/3rd tier Subcontractor/subconsultant

JLA Geosciences, Inc.

Print Name of Prime

By: [Signature]

Authorized Signature

James L. Andersen

Print Name

President

Title

Date: 1/2/2025

Kimley-Horn and Associates, Inc.

Print Name of Subcontractor/subconsultant

By: [Signature]

Authorized Signature

Jason Lee, P.E.

Print Name

Vice President

Title

Date: 1/2/2025



If you have experienced or witnessed a violation of the EBO Ordinance or would like to file a complaint, please scan the QR Code

Revised 09/26/2024

OEBO LETTER OF INTENT – SCHEDULE 2

A completed Schedule 2 is a binding document between the Prime Contractor/consultant and a Subcontractor/subconsultant (for any tier) and should be treated as such. All Subcontractors/subconsultants, including any tiered Subcontractors/subconsultants, must properly execute this document. If a Mandatory API goal applies, failure to submit a properly executed Schedule 2 will result in a determination of non-responsiveness to the solicitation. Each properly executed Schedule 2 must be submitted with the bid/proposal.

SOLICITATION/PROJECT NUMBER: PBCWUD 19-022, CSA#3, Supplement 3.3

SOLICITATION/PROJECT NAME: System-Wide Wellfield Improvements Phase 2 Construction Phase Services

Prime Contractor: JLA Geosciences, Inc. Subcontractor: Electrical Design Associates, Inc.

(Check box(s) that apply)

SBE WBE MBE M/WBE Non-S/M/WBE Date of Palm Beach County Certification (if applicable): 6/7/24-6/6/27

The undersigned affirms they are the following (select one from each column if applicable):

Column 1	Column 2	Column 3
<input checked="" type="checkbox"/> Male <input type="checkbox"/> Female	<input checked="" type="checkbox"/> African-American/Black <input type="checkbox"/> Asian American <input type="checkbox"/> Caucasian American	<input type="checkbox"/> Supplier
	<input type="checkbox"/> Hispanic American <input type="checkbox"/> Native American	

S/M/WBE PARTICIPATION – S/M/WBE Primes must document all work to be performed by their own work force on this form. Specify in detail, the scope of work to be performed or items supplied with the dollar amount and/or percentage for each work item. When applicable, identify the line item(s) associated with the service/product being supplied. S/M/WBE credit will only be given for the areas in which the S/M/WBE is certified. A detailed quote/proposal may be attached to a properly executed Schedule 2 for additional information.

Line Item	Item Description	Unit Price	Quantity/ Units	Contingencies/ Allowances	Total Price/Percentage
	9.03 Electrical Engineering - Industrial Facilities	\$86,027.15	1	-	\$86,027.15
	Commodity Codes: 92500				

The undersigned Subcontractor/subconsultant is prepared to self-perform the above-described work in conjunction with the aforementioned project at the following total price or percentage: \$86,027.15

If the undersigned intends to subcontract any portion of this work to another Subcontractor/subconsultant, please list the business name and the amount below accompanied by a separate properly executed Schedule 2.

N/A

Name of 2nd/3rd tier Subcontractor/subconsultant

Price or Percentage: N/A

JLA Geosciences, Inc.

Print Name of Prime

By: [Signature]

Authorized Signature

James L. Andersen

Print Name

President

Title

Date: 11/18/2024

Electrical Design Associates, Inc.

Print Name of Subcontractor/subconsultant

By: [Signature]

Authorized Signature

Dameion Donaldson, P.E.

Print Name

President

Title

Date: 11/18/2024



If you have experienced or witnessed a violation of the EBO Ordinance or would like to file a complaint, please scan the QR Code

Revised 09/26/2024

OEBO LETTER OF INTENT – SCHEDULE 2

A completed Schedule 2 is a binding document between the Prime Contractor/consultant and a Subcontractor/subconsultant (for any tier) and should be treated as such. All Subcontractors/subconsultants, including any tiered Subcontractors/subconsultants, must properly execute this document. If a Mandatory API goal applies, failure to submit a properly executed Schedule 2 will result in a determination of non-responsiveness to the solicitation. Each properly executed Schedule 2 must be submitted with the bid/proposal.

SOLICITATION/PROJECT NUMBER: PBCWUD 19-022

SOLICITATION/PROJECT NAME: System-Wide Wellfield Improvements Phase 2 Construction Phase Services

Prime Contractor: JLA Geosciences, Inc. Subcontractor: Engineered Design Services LLC

(Check box(s) that apply)

SBE WBE MBE M/WBE Non-S/M/WBE Date of Palm Beach County Certification (if applicable): 11/1/24 - 10/31/27

The undersigned affirms they are the following (select one from each column if applicable):

Column 1	Column 2	Column 3
<input checked="" type="checkbox"/> Male <input type="checkbox"/> Female	<input checked="" type="checkbox"/> African-American/Black <input type="checkbox"/> Asian American <input type="checkbox"/> Caucasian American <input type="checkbox"/> Hispanic American <input type="checkbox"/> Native American	<input type="checkbox"/> Supplier

S/M/WBE PARTICIPATION – S/M/WBE Primes must document all work to be performed by their own work force on this form. Specify in detail, the scope of work to be performed or items supplied with the dollar amount and/or percentage for each work item. When applicable, identify the line item(s) associated with the service/product being supplied. S/M/WBE credit will only be given for the areas in which the S/M/WBE is certified. A detailed quote/proposal may be attached to a properly executed Schedule 2 for additional information.

Line Item	Item Description	Unit Price	Quantity/ Units	Contingencies/ Allowances	Total Price/Percentage
	Engineering Services	(\$20,352.00)	1		(\$20,352.00)
	Commodity Codes: 92588				

The undersigned Subcontractor/subconsultant is prepared to self-perform the above-described work in conjunction with the aforementioned project at the following total price or percentage: (\$20,352.00)

If the undersigned intends to subcontract any portion of this work to another Subcontractor/subconsultant, please list the business name and the amount below accompanied by a separate properly executed Schedule 2.

N/A Price or Percentage: N/A

Name of 2nd/3rd tier Subcontractor/subconsultant

JLA Geosciences, Inc.

Print Name of Prime

By: [Signature]
Authorized Signature

James L. Andersen
Print Name

President

Title

Date: 1/10/2024

Engineered Design Services LLC

Print Name of Subcontractor/subconsultant

By: [Signature]
Authorized Signature

Craig McKenzie, P.E.
Print Name

Manager

Title

Date: 1/10/2024



If you have experienced or witnessed a violation of the EBO Ordinance or would like to file a complaint, please scan the QR Code

ATTACHMENT - D

PROJECT SCHEDULE

The completion dates for this work will be as follows (starting from CONSULTANT'S receipt of Notice-to-Proceed).

Engineering Services	Completion Date from Notice to Proceed (Calendar Days)
Task 1.0 Construction Phase Services	278 Days

Revised 6-12-24

**ATTACHMENT E
BUDGET SUMMARY**

Palm Beach County Water Utilities Department
Contract for Consulting/Professional Services: System-Wide Wellfield Improvements Hydrogeologic, Engineering Design and Construction Services
Resolution No.: R2019-0439 Contract Dated: April 2, 2019
Consultant Service Authorization No.: 3.3
Consultant: JLA Geosciences, Inc.
Project Title: System-Wide Wellfield Improvements Phase 2 Construction Phase Services
PBCWUD Project No.: 19-022

Task No.	Task Description	Labor Classification and Hourly Rate														Sub Consultant Services	TASK TOTAL		
		President	Prin./Hydro Corp. Officer	Pj. Manager Sr Hydro III	Senior Hydro II	Senior Hydro I	Geol / Hydro III	Geol / Hydro II	Geol / Hydro I	Hydro Tech	Admin / Tech	Total Labor	Mileage (\$0.655/mi)	ODC					
1.0	Construction Phase Services																		
1.1	Additional Project Management (9 months)	9.0	72.0																
	Subconsultant - Kinley-Horn and Associates, Inc.																	\$ 12,321.52	\$ 12,321.52
	Subconsultant - Electrical Design Associates, Inc.																	\$ 11,151.87	\$ 11,151.87
1.3	Additional Project Meetings (9 months)		9.0		18.0														
	Subconsultant - Kinley-Horn and Associates, Inc.																	\$ 6,822.54	\$ 6,822.54
	Subconsultant - Electrical Design Associates, Inc.																	\$ 6,761.52	\$ 6,761.52
1.4	Additional Contractor submittal review (12 estimated)		4.5		3.0														
	Subconsultant - Kinley-Horn and Associates, Inc.																	\$ 7,357.60	\$ 7,357.60
	Subconsultant - Electrical Design Associates, Inc.																	\$ 4,787.38	\$ 4,787.38
1.5	Additional Payment Application Review (9 months)		4.5		9.0														
	Subconsultant - Kinley-Horn and Associates, Inc.																	\$ 6,957.61	\$ 6,957.61
	Subconsultant - Electrical Design Associates, Inc.																	\$ 1,314.74	\$ 1,314.74
1.6	Additional Daily Work Reports, Weekly Project Summary Updates (9 months)	4.5	40.5		126.0					40.5									
	Subconsultant - Kinley-Horn and Associates, Inc.																	\$ 12,353.22	\$ 12,353.22
	Subconsultant - Electrical Design Associates, Inc.																	\$ 13,915.53	\$ 13,915.53
1.7	Additional Field Construction oversight (9 months)	4.5	207.0		540.0					211.5									
	Subconsultant - Kinley-Horn and Associates, Inc.																	\$ 29,335.08	\$ 29,335.08
	Subconsultant - Electrical Design Associates, Inc.																	\$ 44,096.11	\$ 44,096.11
1.7.1	Field Construction oversight (Previously under EDS)																		
	Subconsultant - Kinley-Horn and Associates, Inc.																	\$ 24,337.72	\$ 24,337.72
	Subconsultant - Engineered Design Services LLC																	\$ (20,352.00)	\$ (20,352.00)
1.9	Additional Field Construction oversight (9 months)																		
	ODC - Vibrelon Monitoring			18.0						36.0							\$ 24,050.00		\$ 31,241.90
	Subtotal Task 1.0	18.0	337.5	18.0	696.0	0.0	0.0	288.0	0.0	0.0	0.0	1357.5	\$ -	\$ 24,050.00	\$ 165,160.44	\$ 403,585.46			
	Labor Subtotal Hours	18.0	337.5	18.0	696.0	0.0	0.0	288.0	0.0	0.0	0.0						\$ 24,050.00	\$ 165,160.44	
	Labor Hourly Billing Rates	\$ 196.06	\$ 205.00	\$ 174.45	\$ 151.94	\$ 148.00	\$ 129.43	\$ 112.55	\$ 102.00	\$ 67.53	\$ 67.53								
	Labor Raw Costs	\$ 67.92	\$ 71.03	\$ 60.16	\$ 52.39	\$ 50.34	\$ 44.63	\$ 38.81	\$ 35.17	\$ 23.29	\$ 23.29								
	Labor Multiplier	2.9	2.9	2.9	2.9	2.9	2.9	2.9	2.9	2.9	2.9								
	Labor SubTotal	\$ 3,545.28	\$ 69,525.00	\$ 3,140.10	\$ 105,750.24	\$ -	\$ -	\$ 32,414.40	\$ -	\$ -	\$ -								
	Labor Total																		\$214,375.02
	Mileage/ODC																		\$24,050.00
	Subconsultant Total																		\$165,160.44
	Project Total																		\$403,585.46

Mileage calculated based on current US Internal Revenue Service standard rates.

ATTACHMENT - E
BUDGET SUMMARY

Palm Beach County Water Utilities Department

Project Title: System-Wide Wellfield Improvements Phase 2 - Additional Construction Phase Services

WUD Project No.: 19-022

Consultant Service Authorization: 3, Sup. 3.3

Consultant: Electrical Design Associates, Inc.

Task No.	Task Description	Labor Classification and Hourly Rate						Total Labor	TASK TOTAL
		Principal	Senior Electrical Engineer	Engineer	Senior Associate	Cadd Tech	Clerical / Admin		
1.0	Phase 2 Additional Construction Phase Services								
1.1	Additional Project Management (9 month est.)								
	<i>Subcontractor - Electrical Design Associates, Inc.</i>	0	45	14	0	0	7	66	\$ 11,151.67
1.3	Attend additional monthly progress meetings (9 estimated)								
	<i>Subcontractor - Electrical Design Associates, Inc.</i>	0	36	0	0	0	0	36	\$ 6,761.52
1.4	Additional Contractor submittal review (12 estimated)								
	<i>Subcontractor - Electrical Design Associates, Inc.</i>	4	24	16	0	4	6	54	\$ 8,787.38
1.5	Additional Payment Application Review (9 month est.)								
	<i>Subcontractor - Electrical Design Associates, Inc.</i>	0	7	0	0	0	0	7	\$ 1,314.74
1.6	Additional Daily Work Report, Project Summary updates (9 month est.; 38 weeks)								
	<i>Subcontractor - Electrical Design Associates, Inc.</i>	0	54	25	0	0	0	79	\$ 13,915.53
1.7	Provide additional field construction oversight								
1.7.1	Provide additional field construction oversight during rehabilitation, abandonments, and electrical improvements for 9 wells - WTP 2 & 8 (9 month est.)								
	<i>Subcontractor - Electrical Design Associates, Inc.</i>	5	140	62	0	45	22	274	\$ 44,096.11
	Subtotal Task 2	9	306	117	0	49	36	516.0	
	Labor Subtotal Hours	9	306	117	0	49	35		
	Labor Hourly Billing Rates	\$ 218.01	\$ 187.82	\$ 150.93	\$ 134.16	\$ 122.42	\$ 83.85		
	Labor Raw Costs	\$ 73.16	\$ 63.03	\$ 50.65	\$ 45.02	\$ 41.08	\$ 28.14		
	Labor Multiplier	2.98	2.98	2.98	2.98	2.98	2.98		
	Labor SubTotal	\$ 1,962.09	\$ 57,472.92	\$ 17,858.81	\$ -	\$ 5,998.58	\$ 2,934.75		\$ 86,027.15
	Labor Total								\$86,027.15
	Mileage/ODC								\$0.00
	Subconsultant Total								\$86,027.15

PBCWUD 19-022, Phase 2 Amendment 3.3

ATTACHMENT - A									
BUDGET SUMMARY									
Labor Classification and Hourly Rate									
Task	Q/C	Senior	Professional	Designer	Engineering	Support	Total	Sub	
Number	Task Description	Principal	PROJ		Intern	Staff	Labor	Consultant	
		MGR			Analyst			Services	
1.0	Additional Const. Phase Services								
1.1	Additional Project Management (9 months)	18		36		4	\$12,321.52		
1.3	Additional Project Meetings (9 months)	9		18		9	\$6,822.54		
1.4	Additional Contractor submittal review (12 estimated)	6		12	24	4	\$7,357.60		
1.5	Additional Payment Application Review (9 months)	9		9	18	4	\$6,957.61		
1.6	Additional Daily Work Reports, Weekly Project Summary Updates (9 months)	9		36	18	9	\$12,353.22		
1.7	Additional Field Construction oversight (9 months)			54	120	9	\$29,335.08		
1.7.1	Field Const. Oversight (Previously under EDS)								
	Project Management		10				\$2,599.90		
	Review concrete formwork				23		\$2,873.39		
	Review rebar				23		\$2,873.39		
	Review concrete pours				64		\$7,995.52		
	Review concrete test cylinders				10		\$1,249.30		
	Review slump tests				10		\$1,249.30		
	Review Densities on subgrades				10		\$1,249.30		
	Review concrete mix submittal				10		\$1,249.30		
	Inspection Logs				24		\$2,998.32		
	<i>Subtotal Task 1</i>	51	10	165	120	234	39	\$99,485.29	\$0
	Labor Subtotal Hours	51	10	165	120	234	39		
	ANNUAL ESCALATOR	0%	0%	0%	0%	0%	0%		
	RAW LABOR (\$/HOUR)	\$ 99.62	\$ 86.66	\$ 60.76	\$ 51.77	\$ 41.64	\$ 31.51		
	Labor Multiplier	3.0	3.0	3.0	3.0	3.0	3.0		
	Labor Rate	\$ 298.86	\$ 259.99	\$ 182.33	\$ 155.32	\$ 124.93	\$ 94.54		
	Labor Total	\$15,241.86	\$2,599.90	\$30,084.45	\$18,638.40	\$29,233.62	\$3,687.06	\$99,485.29	
	Project Total								\$99,485.29

ATTACHMENT F

Palm Beach County Water Utilities Department

Contract for Consulting/Professional Services

System-Wide Wellfield Improvements Phase 2 Construction Phase Services

Resolution No. R2019-0439

Contract Dated: 4/2/2019

SUMMARY OF SBE-M/WBE BUSINESS TRACKING

Master Contract Goals	SBE: 59.00%	M/WBE: 22.00%	MWBE (Black): 1.00%	MWBE (Hispanic): 20.00%	MWBE (Women): 1.00%
Current Proposal					
Value of Authorization No. <u>3.3</u>	\$ 403,585.46				
Value of SBE-M/WBE Letters of Intent	\$ 304,100.17	\$ 65,675.15	\$ 65,675.15	\$ -	\$ -
Actual Percentage	75.34%	16.27%	16.27%	0.00%	0.00%
Signed/Approved Authorizations					
Total Value of Authorizations	\$ 4,648,177.14				
Total Value of SBE-M/WBE Signed Subcontractors	\$ 3,671,134.88	\$ 1,895,287.22	\$ 89,527.28	\$ 974,835.14	\$ 45,860.00
Actual Percentage	78.98%	40.77%	1.92%	20.97%	0.98%
Signed/Approved Authorizations Plus Current Proposal					
Total Value of Authorizations	\$ 5,051,762.60				
Total Value of Subcontractors & Letters of Intent	\$ 3,975,235.05	\$ 1,960,962.37	\$ 155,202.43	\$ 974,835.14	\$ 45,860.00
Actual Percentage	78.69%	38.81%	3.07%	19.29%	0.90%

Revised 6-12-24

ATTACHMENT G

Project Title: System-Wide Wellfield Improvements Phase 2 Construction Phase Services
PBCWUD Project No.: 19-022, Supplement 3.3

Location Map

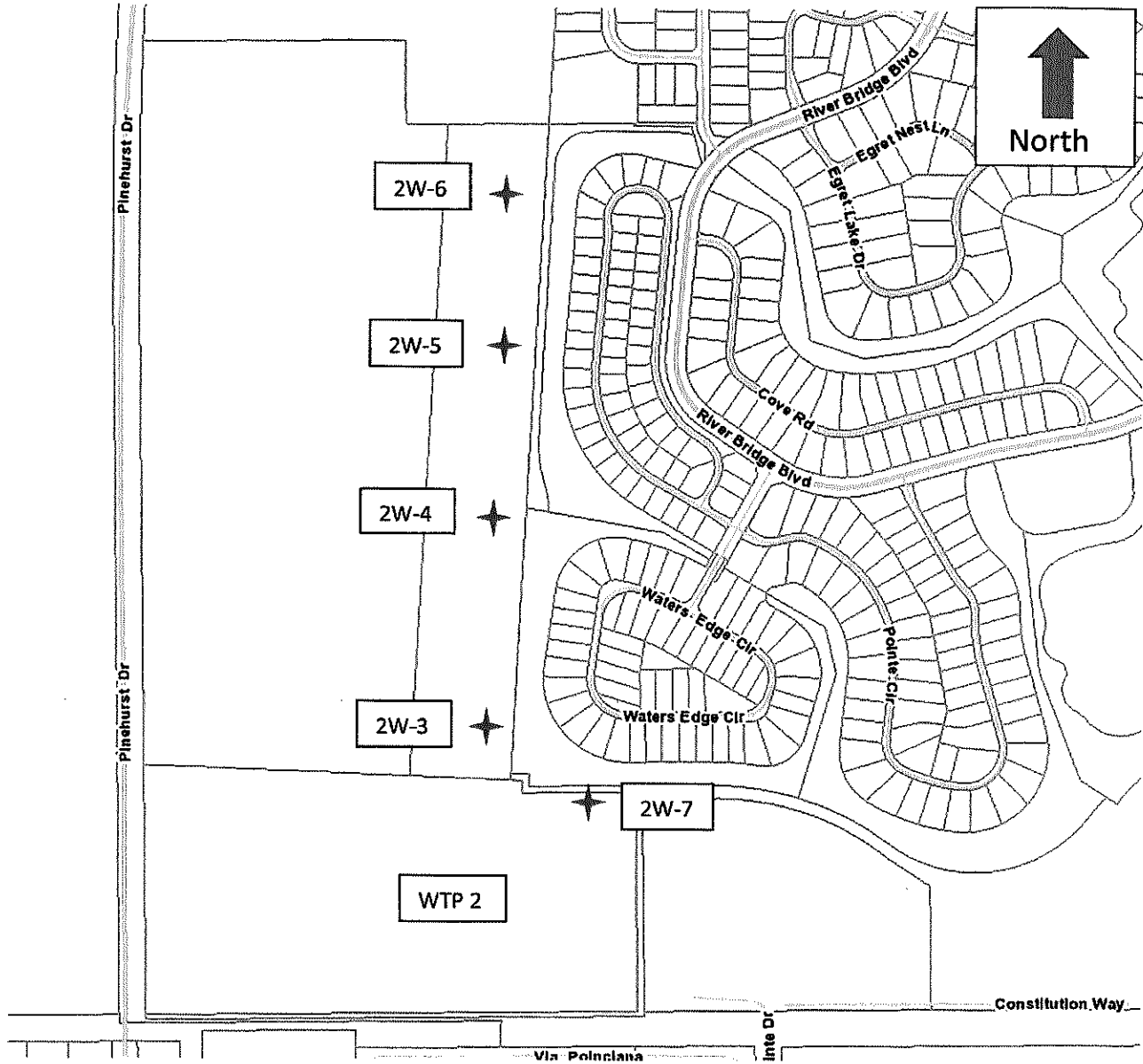

★ Well Locations

Not to Scale

WTP 2 – Water Treatment Plant No. 2

Revised 06-12-24

ATTACHMENT G

Project Title: System-Wide Wellfield Improvements Phase 2 Construction Phase Services
PBCWUD Project No.: 19-022, Supplement 3.3

Location Map

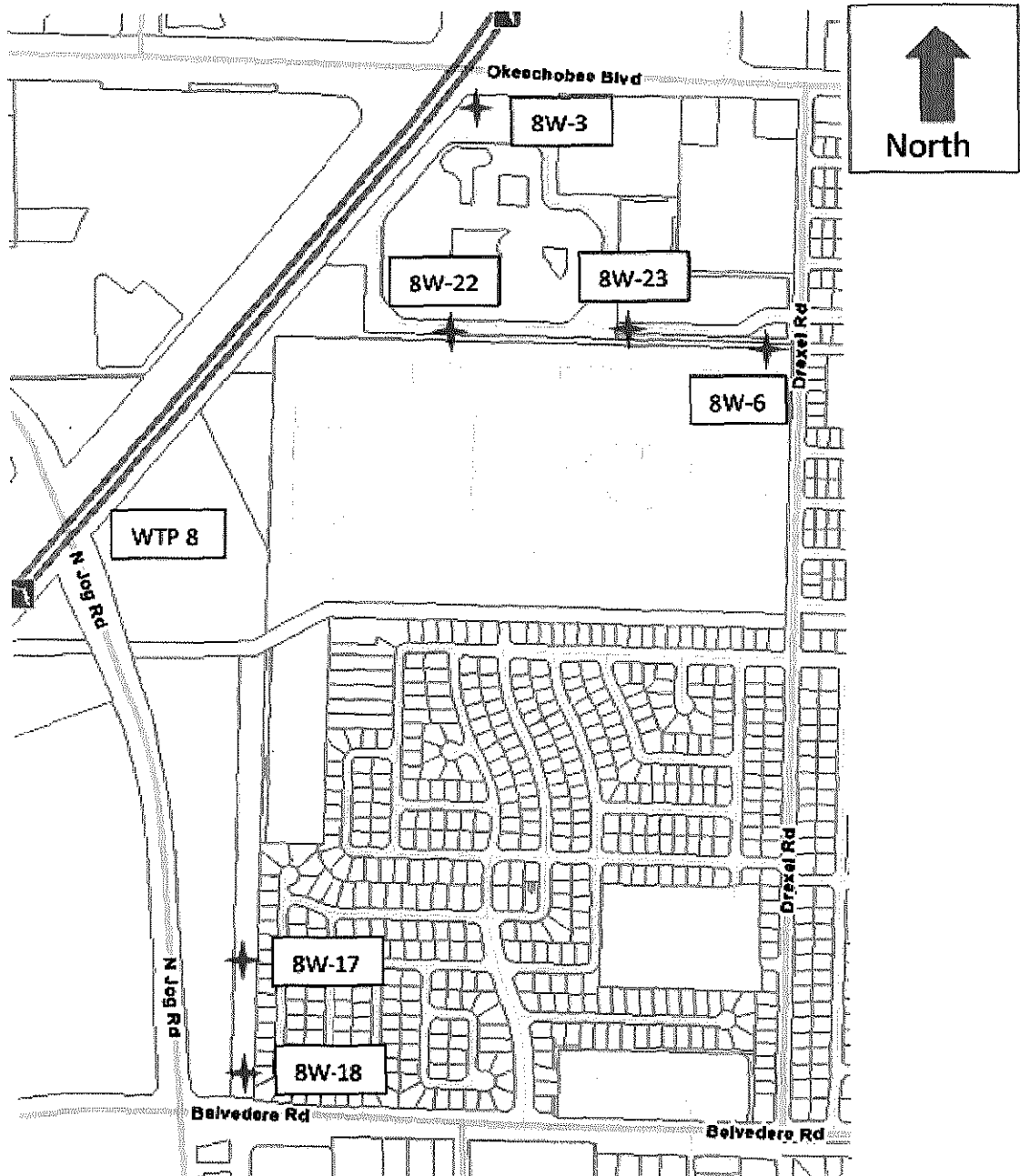

★ Well Locations

Not to Scale

WTP 8 – Water Treatment Plant No. 8

Revised 06-12-24

**ATTACHMENT H
EDS DOCUMENTATION**



February 12, 2024

Rani K. Smith, P.G.
Principal Hydrogeologist
JLA Geosciences, Inc.
1907 Commerce Lane, Suite 104
Jupiter, Florida 33458

RE: WUD 19-022 Phase 2 CPS

Ms. Smith:

I regret to inform you that Engineered Design Services (EDS) is unable to perform the work for WUD 19-022 Phase 2 Construction Phase Services, due to the resignation of a staff member handling these services. We have explored options to fulfill this scope of work, and it has proved very challenging to find staff to provide service specific to this project while maintain consistent coverage of the schedule requirements.

I hope the response above provides additional clarity regarding our resignation from this project. Should you have any questions, please do not hesitate to contact me.

Sincerely,

Craig McKenzie, P.E.
President/CEO
Engineered Design Services LLC

ATTACHMENT - E
BUDGET SUMMARY

Palm Beach County Water Utilities Department
Contract for Consulting/Professional Services

Resolution #
Consultant: Engineered Design Services LLC
Project Title: Wellfield Improvements - Phase 2 CEI Support Services
WUD Project No: 19-022

Labor Classification and Hourly Rate

Task No.	Task Description	Principal Engineer	Project Manager	Project Engineer	Engineer Intern	Eng Tech	Designer	Total Labor	Mileage (\$0.58/mi)	ODC	Task Total
*Task 0	Project Management		10					10	\$ -	\$ -	\$ 1,560.00
*Task 1	Inspect all concrete form work				23			23	\$ -	\$ -	\$ 2,484.00
*Task 2	Inspect all rebar				23			23	\$ -	\$ -	\$ 2,484.00
*Task 3	Witness all concrete pours				64			64	\$ -	\$ -	\$ 6,912.00
*Task 4	Ensure concrete test cylinders are taken during pour				10			10	\$ -	\$ -	\$ 1,080.00
*Task 5	Witness slump tests				10			10	\$ -	\$ -	\$ 1,080.00
*Task 6	Ensure passing densities on subgrade are taken prior to pour				10			10	\$ -	\$ -	\$ 1,080.00
*Task 7	Can include reviewing the concrete mix submittal if needed				10			10	\$ -	\$ -	\$ 1,080.00
*Task 8	Daily inspection logs (submitted daily) for any site visits				24			24	\$ -	\$ -	\$ 2,592.00
	Labor Subtotal Hours	0	10	0	174	0	0				
	Labor Hourly Billing Rates	\$ 189.00	\$ 156.00	\$ 125.00	\$ 108.00	\$ 70.00	\$ 70.00				
	Labor Raw Costs	\$ 72.79	\$ 57.35	\$ 45.96	\$ 39.71	\$ 25.74	\$ 25.74				
	Labor Multiplier	2.72	2.72	2.72	2.72	2.72	2.72				
	Labor Subtotal	\$ -	\$ 1,560.00	\$ -	\$ 18,792.00	\$ -	\$ -				
	Labor Total										\$20,352.00
	Mileage/ODC										\$0.00
	Project Total										\$20,352.00



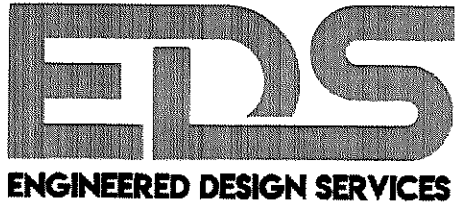

Proposal to: JLA Geosciences

WUD 19-022
Wellfield Improvements—Phase 2
CEI Support Services

Submitted 6/11/14

Engineered Design Services LLC
Contact: Craig McKenzie, P.E.
CraigMcKenzie@EDSEngineers.com
(352)284-7573

edsengineers.com

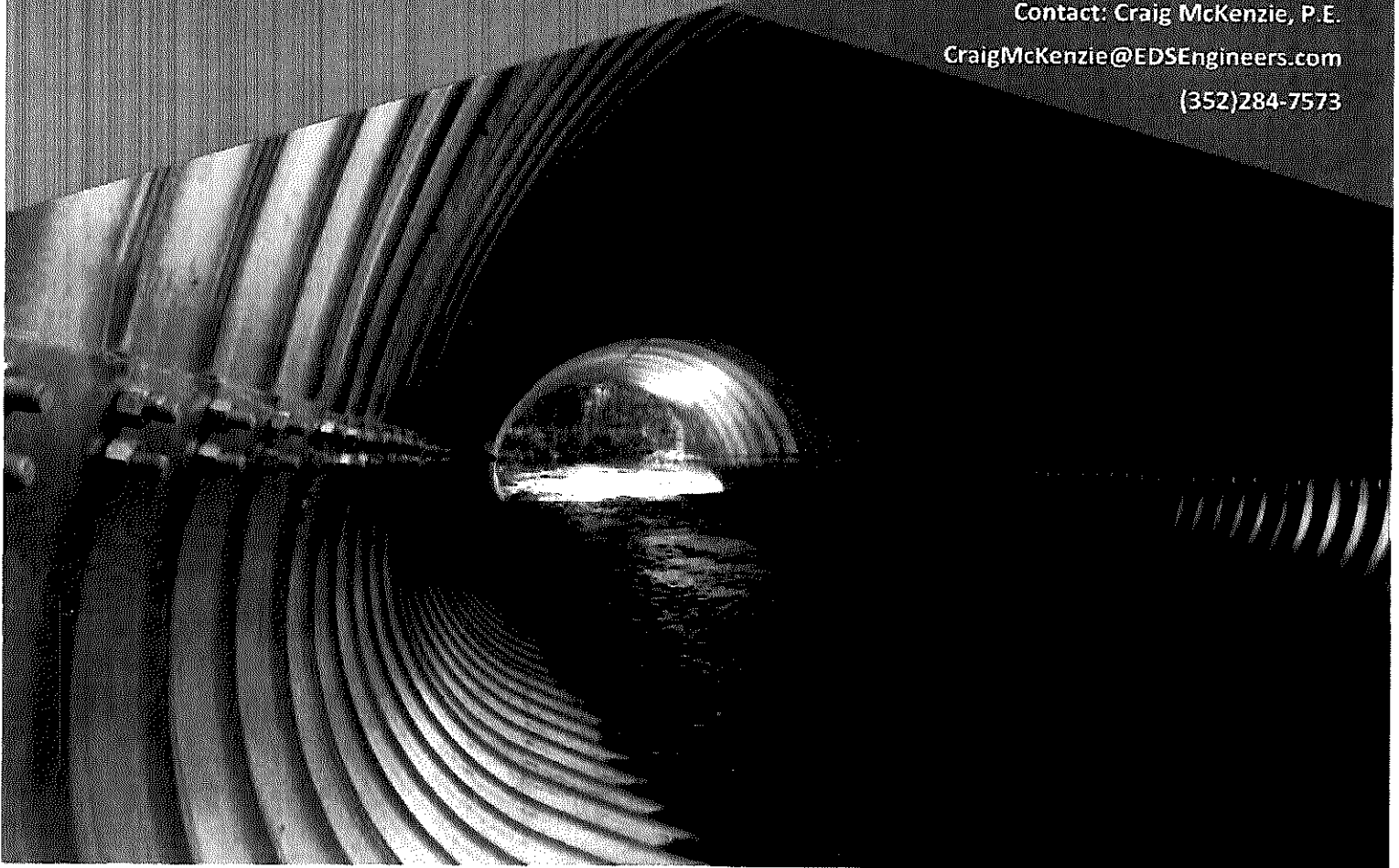

June 11, 2021

Rani K. Smith, P.G.
Principal Hydrogeologist
JLA Geosciences, Inc.
1907 Commerce Lane, Suite 104
Jupiter, FL 33458

RE: Proposal for WUD 19-022 Phase 2—CEI Support Services

Dear Ms. Smith:

Engineered Design Services (EDS) is pleased to support JLA Geosciences (JLA) in the construction phase of WUD 19-022 Systemwide Wellfield Improvements Project—Phase 1. We understand that a total of 9 production wells will be refurbished under this contract, and will require on-site support during construction. As a sub-contractor to JLA, EDS proposes the following partial construction management services.

CONSTRUCTION PHASE SCOPE OF SERVICES:

Our proposed scope of services will include the following services at the 14 well locations in Phase I:

WTP 2 Wells: 2W-3/2W-3R, 2W-4/2W-4R, 2W-5/2W-5R, 2W-6/2W-6R, 2W-7/2W-7R
WTP 8 Wells: 8W-6, 8W-17, 8W-18, 8W-23

- Inspect all concrete form work
- Inspect all rebar
- Witness all concrete pours
- Ensure concrete test cylinders are taken during pour
- Witness slump tests
- Ensure passing densities on subgrade are taken prior to pour
- Can include reviewing the concrete mix submittal if needed
- Daily inspection logs (submitted daily) for any site visits

Exclusions

- *Site Survey, Site Planning Services, CA Services, construction estimate, LEED Services, As-Built Set, and owner requested changes are not included in scope of services.*

Project Specific Quality Control Plan

EDS intends to ensure the quality of our projects in the following manner:

JOB SAFETY ANALYSIS

- At Engineered Design Services, we believe that safety is the key to success in all construction projects. As a result, we carefully plan out our activities prior to the site visit, and perform a safety review before each site visit. Craig McKenzie, P.E. will be in charge of safety for the project team.

PERSONAL PROTECTIVE EQUIPMENT

- EDS provides all staff with the required safety equipment for the project including, but not limited to, eye protection, steel toe boots, hi-viz vests, hearing protection, etc.
- During our JSA, we will identify any additional equipment or procedures to ensure safe working activities.

PROJECT DOCUMENTATION

- Project documentation created will be checked internally by Craig and other project professionals prior to submission to JSA.
- All project documentation will be memorialized in a Project QA/QC Book, per EDS standards.

KEY ADVANTAGES:

Flexibility
Attention to Detail
Local Knowledge of Site

KEY PERSONNEL:

Craig McKenzie, P.E., CGC
Ricardo Rennalls
Sancho Barrett

Project Pricing

We have developed a time and materials budget for the WUD 19-022 Phase 2 project based on our understanding of the scope provided.

The T&M not-to exceed fee for EDS to provide the scope of work tasks and services shall be \$20,352, based on the task breakdown below for all 9 project sites.

BUDGET SUMMARY BY TASK						
TASK	DESCRIPTION	HOURS	RATE	LABOR \$	EXPENSE \$	TOTAL \$
*Task 0	Project Management	10	156	\$1,560	\$0	\$1,560
*Task 1	Inspect all concrete form work	23	108	\$2,484	\$0	\$2,484
*Task 2	Inspect all rebar	23	108	\$2,484	\$0	\$2,484
*Task 3	Witness all concrete pours	64	108	\$6,912	\$0	\$6,912
*Task 4	Ensure concrete test cylinders are taken during	10	108	\$1,080	\$0	\$1,080
*Task 5	Witness slump tests	10	108	\$1,080	\$0	\$1,080
*Task 6	Ensure passing densities on subgrade are taken	10	108	\$1,080	\$0	\$1,080
*Task 7	Can include reviewing the concrete mix submittals	10	108	\$1,080	\$0	\$1,080
*Task 8	Daily inspection logs (submitted daily) for any	24	108	\$2,592	\$0	\$2,592
*Note: Hours are cumulative for all 9 well sites						
TOTALS		174		\$ 20,352	\$ -	\$ 20,352

We appreciate the opportunity to provide this proposal and look forward to working with you. Should you have any questions, please do not hesitate to contact us.

Respectfully Submitted,

Craig McKenzie, P.E.
 President/Principal Engineer
 Engineered Design Services LLC

Offer Accepted by:

Signature: _____

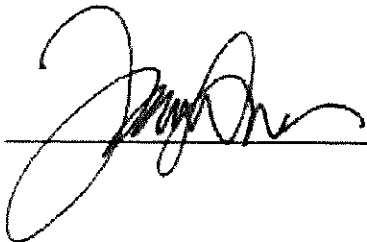

Date: 10/1/2021

SUBCONSULTANT PROPOSALS

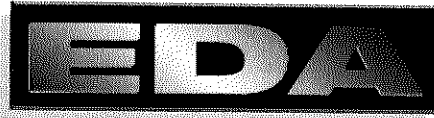

November 18, 2024

Electrical Design Associates

Ms. Rani K. Smith, P.G.
Principal Hydrogeologist
JLA Geosciences, Inc.
1907 Commerce Lane, Suite 104
Jupiter, Florida 33458

Re: System-Wide Wellfield Improvements Phase 2 – Additional Construction Phase Services
Project Number: WUD 19-022, CSA#3, Supplement 3.3
Palm Beach County, FL

Dear Ms. Smith:

We are pleased to submit our revised proposal for additional general services during construction as it relates to the electrical design for the above referenced project. The following serves to provide an overview of the engineering services Electrical Design Associates, Inc. (EDA) intends to furnish on the above referenced project to JLA Geosciences, Inc (JLA). Your signature on this agreement will serve as your letter of intent.

The project originally included 30 months of anticipated construction oversight. However, based on the current Contractor schedule and WUD-approved change orders, the project looks to extend to an estimated 39 months of construction oversight and progress meetings.

Our services shall include additional general services during construction and shall include the following:

TASK 1.0 PHASE 2: ADDITIONAL CONSTRUCTION PHASE SERVICES

- Task 1.1 Additional Project Management (9 months estimated)** – EDA shall assist JLA in providing additional project coordination with COUNTY representatives and Construction Contractor and overall general project management during field services.
- Task 1.3 Additional Progress Meetings (9 estimated)** – EDA shall attend nine (9) additional construction progress meeting at periods appropriate to the various stages of construction as necessary based on the progress of the job and estimated hours provided herein, throughout the duration of the project (9 months). Concurrently on the day of the monthly construction progress meeting, observe the construction of the project and discuss any concerns with the COUNTY.
- Task 1.4 Additional Contractor submittal review (12 estimated)** - EDA shall review additional contractor submitted shop drawings and submittals for electrical, instrumentation and all mechanical equipment with electrical and/or instrumentation interface (12 estimated). EDA shall respond to reasonable and appropriate Contractor requests for information (RFI) and issue necessary clarifications and interpretations of the Contract Documents to the COUNTY as appropriate to the orderly completion of the Contractor's work. The hourly estimate is based on four (4) RFIs.
- Task 1.5 Additional Payment Application Review (9 months estimated)** – EDA shall assist JLA with additional review and provide recommendations for the acceptance of the contractor submitted payment applications (9 estimated).

7284 WEST PALMETTO PARK RD, SUITE 302-S
BOCA RATON, FL 33433

Task 1.6 Additional Daily Work Reports, Weekly Project Summary Updates (9 months estimated; 38 weeks) – EDA shall provide assistance to JLA in preparing additional daily work report for site inspection activities and submit to the COUNTY on a weekly basis during well field construction activities. EDA's assistance includes preparation of the electrical weekly report based on site visit and/or coordination activities performed during the week. The hourly estimate is based one (1) site visit per week.

Task 1.7 Additional Field Construction oversight (9 months estimated)

Task 1.7.1 Additional Field Construction oversight – WTP 2 & 8 Well Replacement/Rehabilitation for 9 wells (9 months estimated) – EDA shall provide additional oversight, development, testing during critical phases of construction for the electrical and instrumentation improvements. One (1) site visit per week is assumed during the duration of major field work associated with the electrical system. Digital photos will be taken of significant activities during well construction.

EDA shall provide coordination and management of electrical improvements, including field assistance during well startup, examining startup documentation provided by vendors, providing troubleshooting assistance to the Contractor and providing guidance to the COUNTY.

Task 1.0 – Assumptions

- All coordination with COUNTY shall be through Project Manager, Nicole Patriese Gumbs, P.E., PMP.
- Project job trip reports shall be delivered in electronic format compatible with MS Office 2016 and Adobe Acrobat in accordance with the project schedule.
- Construction oversight is based on the final design construction schedule (approximately 8 months). EDA shall be onsite during critical phases of electrical construction only.
- EDA shall not be responsible for the acts or omissions of a Contractor, or of any of their subcontractors, suppliers, or of any other individual or entity performing or furnishing the Work.
- No permitting costs are included in this Task.
- Visits and observations by EDA are not intended to be exhaustive or to extend to every aspect of the Contractor's work in progress. Observations are to be limited to spot checking, selective measurement, and similar methods of general observation of the Work based on EDA's exercise of professional judgement. Based on the information obtained during such visits and such observations, EDA will determine if the Contractor's work is generally proceeding in accordance with the Contract Documents, and EDA shall keep the COUNTY informed of the general progress of the work through weekly reporting.
- The purpose of EDA's visits to the site will be to enable EDA to better carry out the duties and responsibilities outlined in this CSA to provide the COUNTY a greater degree of confidence that the completed Work will confirm in general to the Contract Documents and that the integrity of the design concept of the completed project as a functioning whole as indicated in the Contract Documents has been implemented and preserved by the Contractor. EDA shall not, during such visits or as a result of such observations of the Contractor's work

in progress, supervise, direct, or have control over the Contractor's work, nor shall EDA have authority over or responsibility for the means, methods, techniques, equipment choice and usage, sequences, schedules, or procedures of construction selected by the Contractor, for safety precautions and programs incident to the Contractor's work, nor for any failure of the Contractor to comply with laws and regulations applicable to the Contractor's furnishing and performing the Work. Accordingly, EDA neither guarantees the performance of any Contractor nor assumes responsibility for any Contractor's failure to furnish and perform its work in accordance with the Contract Documents.

- EDA shall recommend to the COUNTY that the Contractor's work be disapproved and rejected while it is in progress if, on the basis of such observations, EDA believes that such work will not produce a completed Project that confirms generally to the Contractor Documents or that it will prejudice the integrity of the design concept of the completed Project as a functioning whole as indicated in the Contract Documents. EDA shall not have the authority or responsibility to stop the work of any Contractor.

Our scope of work shall be as outlined above and as indicated on the attached estimate of work effort. Services not specifically defined are not included. Additional services can be provided under separate Scope of Service(s) or by an amendment to this Scope of Services. Travel to and from the site and other direct costs are included in the overhead rate and will not be billed as a separate line item. Our fee for this work shall be billed lump sum, billed monthly, and shall be payable as follows:

Task 1.1 Additional Project Management	\$	11,151.87
Task 1.3 Additional Progress Meetings	\$	6,761.52
Task 1.4 Additional Contractor Submittal Review	\$	8,787.38
Task 1.5 Additional Payment Application Review	\$	1,314.74
Task 1.6 Add. Daily Work Reports/Wkly Proj. Summary	\$	13,915.53
Task 1.7.1 Add. Field Const. Oversight – WTP 2 & 8	<u>\$</u>	<u>44,096.11</u>
Total:	\$	86,027.15

Very truly yours,



Dameion Donaldson, P.E.

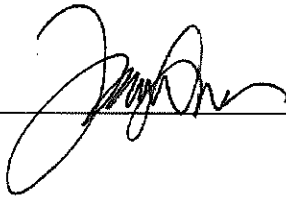

ACCEPTED _____ DATE 11/20/2024

Enclosures



January 2, 2025

Ms. Rani Smith, P.G.
JLA Geosciences, Inc.
1907 Commerce Lane, Suite 104
Jupiter, FL 33458

**RE: CONSTRUCTION PHASE SERVICES AMENDMENT 3.3
SYSTEM-WIDE WELLFIELD IMPROVEMENTS
PROJECT No. WUD 19-022, Phase 2**

Dear Ms. Smith:

We are pleased to provide this amendment for professional services for the construction phase services associated with the Palm Beach County Water Utilities Department System-Wide Wellfield Improvements Phase 2 project.

BACKGROUND

On September 28, 2021, Kimley-Horn and Associates, Inc. (KH) was authorized as a subconsultant to JLA Geosciences, Inc. (JLA) to perform construction phase services for the PBCWUD 19-022 Phase 2 Systemwide Wellfield Improvements Project. Change orders in the project have pushed the final completion date of the project from 31 months after Notice to Proceed (NTP) to 40 months after NTP. This amendment serves to provide construction phase services for the additional nine months to final completion.

This amendment also serves to provide construction phase services for the Well slab concrete placements. Previously, this work was included in the scope of services for Engineered Design Services, LLC (EDS). EDS has since removed themselves from the contract. KH was requested to perform this scope of work.

SCOPE OF SERVICES

CONSULTANT, Kimley-Horn and Associates, Inc. (KHA) serving as a SUBCONSULTANT to JLA Geosciences, Inc, the PRIME CONSULTANT (JLA), shall perform the Scope of Services as described herein and will be responsible for the following tasks:

Task 1.0 Construction Phase Services

Task 1.1 Additional Project Management (9 months) – The SUBCONSULTANT will provide project management coordination with the COUNTY representatives and overall general project management during field services.

Task 1.3 Additional Project Meetings (9) – The SUBCONSULTANT will attend monthly progress meetings, up to nine additional meetings with the COUNTY

and the Contractor during the anticipated construction process. The SUBCONSULTANT will provide bullet meeting minute items to be formalized by PRIME CONSULTANT.

- Task 1.4 Additional Contractor submittal review (12 estimated)** - Subconsultant will respond to Requests for Additional Information (RAI's), and review of change orders.

The SUBCONSULTANT shall recommend to the PRIME CONSULTANT and the COUNTY that the Contractor's work be disapproved and rejected while it is in progress if, on the basis of such observations, the SUBCONSULTANT believes that such work will not produce a completed Project that conforms generally to the Contract Documents or that it will prejudice the integrity of the design concept of the completed Project as a functioning whole as indicated in the Contract Documents. The SUBCONSULTANT shall not have the authority or responsibility to stop the work of any Contractor.

The SUBCONSULTANT will issue necessary clarifications and interpretations of the Contract Documents in response to RAIs and will respond in written format in a timely manner. Any orders authorizing variations from the Contract Documents will be made by the COUNTY.

The SUBCONSULTANT may recommend Change Orders to the COUNTY and will review and make recommendations related to Change Orders submitted or proposed by the Contractor.

- Task 1.5 Payment Application Review (9)** – The SUBCONSULTANT will recommend amounts that the Contractor be paid based on its observations and review of applications for payment and accompanying supporting documentation (up to 9 additional payment applications). Such recommendations of payment will be in writing and will constitute the SUBCONSULTANT'S representation to the COUNTY, based on such observations and review, that, to the best of the SUBCONSULTANT'S knowledge, information, and belief, the Contractor's work has progressed to the point indicated and that such work-in-progress is generally in accordance with the Contract Documents subject to any qualifications stated in the recommendation.

- Task 1.6 Additional Daily Work Reports, Weekly Project Summary Updates (9 months)** – The SUBCONSULTANT shall provide a field report for all field construction oversight to the PRIME CONSULTANT. The SUBCONSULTANT shall summarize the project progress in a weekly project summary update.

- Task 1.7 Additional Field Construction oversight (9 months)** – The SUBCONSULTANT will provide approximately six (6) hours per week for onsite construction observation. Onsite observation will be performed during critical phases of civil and mechanical construction. The SUBCONSULTANT shall prepare field observation reports for onsite observations during critical phases of construction and submit reports to the PRIME CONSULTANT and the COUNTY on a weekly basis during construction activities.

Visits and observations by the SUBCONSULTANT are not intended to be exhaustive or to extend to every aspect of the Contractor's work in progress. Observations are to be limited to spot checking, selective measurement, and similar methods of general observation of the Work based on the SUBCONSULTANT'S exercise of professional judgment. Based on information obtained during such visits and such observations, the SUBCONSULTANT will determine if the Contractor's work is generally proceeding in accordance with the Contract Documents, and the SUBCONSULTANT shall keep the PRIME CONSULTANT and the COUNTY informed of the general progress of the Work.

The purpose of the SUBCONSULTANT'S visits to the site will be to enable the SUBCONSULTANT to better carry out the duties and responsibilities assigned in this Work Task Order to the SUBCONSULTANT during the construction phase by PRIME CONSULTANT and the COUNTY, and, in addition, by the exercise of the SUBCONSULTANT'S efforts, to provide the COUNTY a greater degree of confidence that the completed Work will conform in general to the Contract Documents and that the integrity of the design concept of the completed Project as a functioning whole as indicated in the Contract Documents has been implemented and preserved by the Contractor. The SUBCONSULTANT shall not, during such visits or as a result of such observations of the Contractor's work in progress, supervise, direct, or have control over the Contractor's work, nor shall the SUBCONSULTANT have authority over or responsibility for the means, methods, techniques, equipment choice and usage, sequences, schedules, or procedures of construction selected by the Contractor, for safety precautions and programs incident to the Contractor's work, nor for any failure of the Contractor to comply with laws and regulations applicable to the Contractor's furnishing and performing the Work. Accordingly, the SUBCONSULTANT neither guarantees the performance of any Contractor nor assumes responsibility for any Contractor's failure to furnish and perform its work in accordance with the Contract Documents.

Task 1.7.1 Phase 2 Field Construction Oversight (Previously under EDS contract) –
The SUBCONSULTANT will provide onsite construction observations for the concrete placements of the Well slabs. SUBCONSULTANT will review the concrete mix shop drawing for conformance with the project documents. SUBCONSULTANT will review concrete formwork, rebar and subgrade densities. SUBCONSULTANT will review concrete pours, slump tests and concrete test cylinders. SUBCONSULTANT will provide a field summary report after each concrete placement.

Visits and observations by the SUBCONSULTANT are not intended to be exhaustive or to extend to every aspect of the Contractor's work in progress. Observations are to be limited to spot checking, selective measurement, and similar methods of general observation of the Work based on the SUBCONSULTANT'S exercise of professional judgment. Based on information obtained during such visits and such observations, the SUBCONSULTANT will determine if the Contractor's work is generally proceeding in accordance with the Contract Documents, and the

SUBCONSULTANT shall keep the PRIME CONSULTANT and the COUNTY informed of the general progress of the Work.

The purpose of the SUBCONSULTANT'S visits to the site will be to enable the SUBCONSULTANT to better carry out the duties and responsibilities assigned in this Work Task Order to the SUBCONSULTANT during the construction phase by PRIME CONSULTANT and the COUNTY, and, in addition, by the exercise of the SUBCONSULTANT'S efforts, to provide the COUNTY a greater degree of confidence that the completed Work will conform in general to the Contract Documents and that the integrity of the design concept of the completed Project as a functioning whole as indicated in the Contract Documents has been implemented and preserved by the Contractor. The SUBCONSULTANT shall not, during such visits or as a result of such observations of the Contractor's work in progress, supervise, direct, or have control over the Contractor's work, nor shall the SUBCONSULTANT have authority over or responsibility for the means, methods, techniques, equipment choice and usage, sequences, schedules, or procedures of construction selected by the Contractor, for safety precautions and programs incident to the Contractor's work, nor for any failure of the Contractor to comply with laws and regulations applicable to the Contractor's furnishing and performing the Work. Accordingly, the SUBCONSULTANT neither guarantees the performance of any Contractor nor assumes responsibility for any Contractor's failure to furnish and perform its work in accordance with the Contract Documents.

PROJECT SCHEDULE

The completion dates for this work will be as follows (starting from KH (SUBCONSULTANT'S) receipt of Notice-to-Proceed).

TASK 1.0

9 Months

ITEMS NOT INCLUDED IN THIS SCOPE OF SERVICES

1. Engineering design
2. Further construction phase services not identified in this scope of work

Compensation

The services included in this proposal are intended to be on an hourly basis not to exceed a total value of \$99,485.29. Attached is the fee schedule by task.

KHA will provide these services in accordance with the Contract, Project WUD 18-051, TR07 made executed by and between Palm Beach County, a Political Subdivision of the State of Florida, by and through its Board of Commissioners, hereinafter referred to as the COUNTY, and JLA Geosciences, Inc., authorized to do business in the State of Florida, hereinafter referred to as the CONSULTANT, whose Federal I.D. is 45-0496499.

Please call if you have any questions.

Sincerely,



Jason Lee, P.E.
Vice President

Attachment: **FEE SCHEDULE**

ATTACHMENT 2

Project Title: System-Wide Wellfield Improvements Phase 2 Construction Phase Services
WUD Project No.: 19-022

Location Map

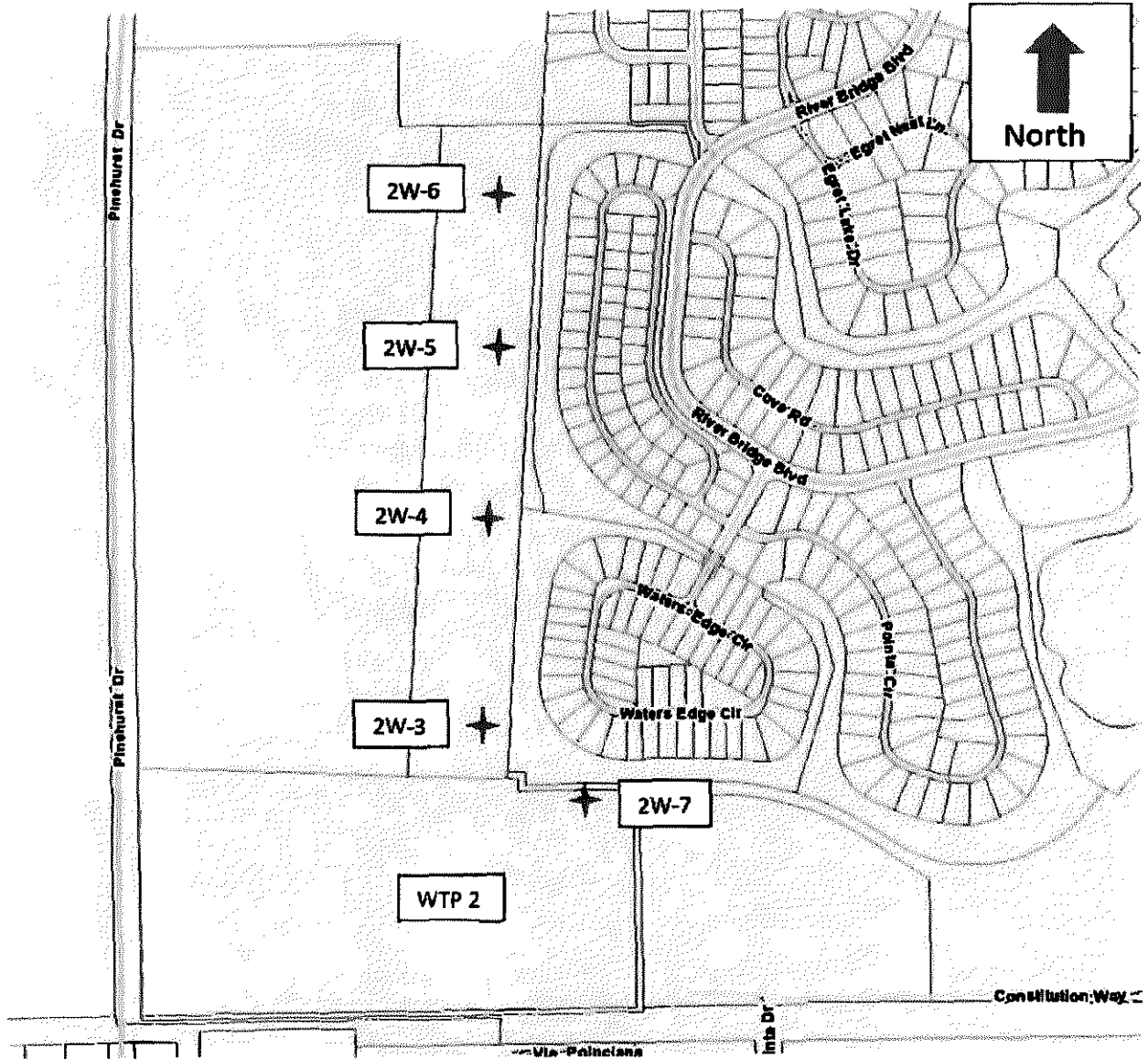

★ Well Locations

Not to Scale

WTP 2 – Water Treatment Plant No. 2

Revised 04/26/2021

Location Map

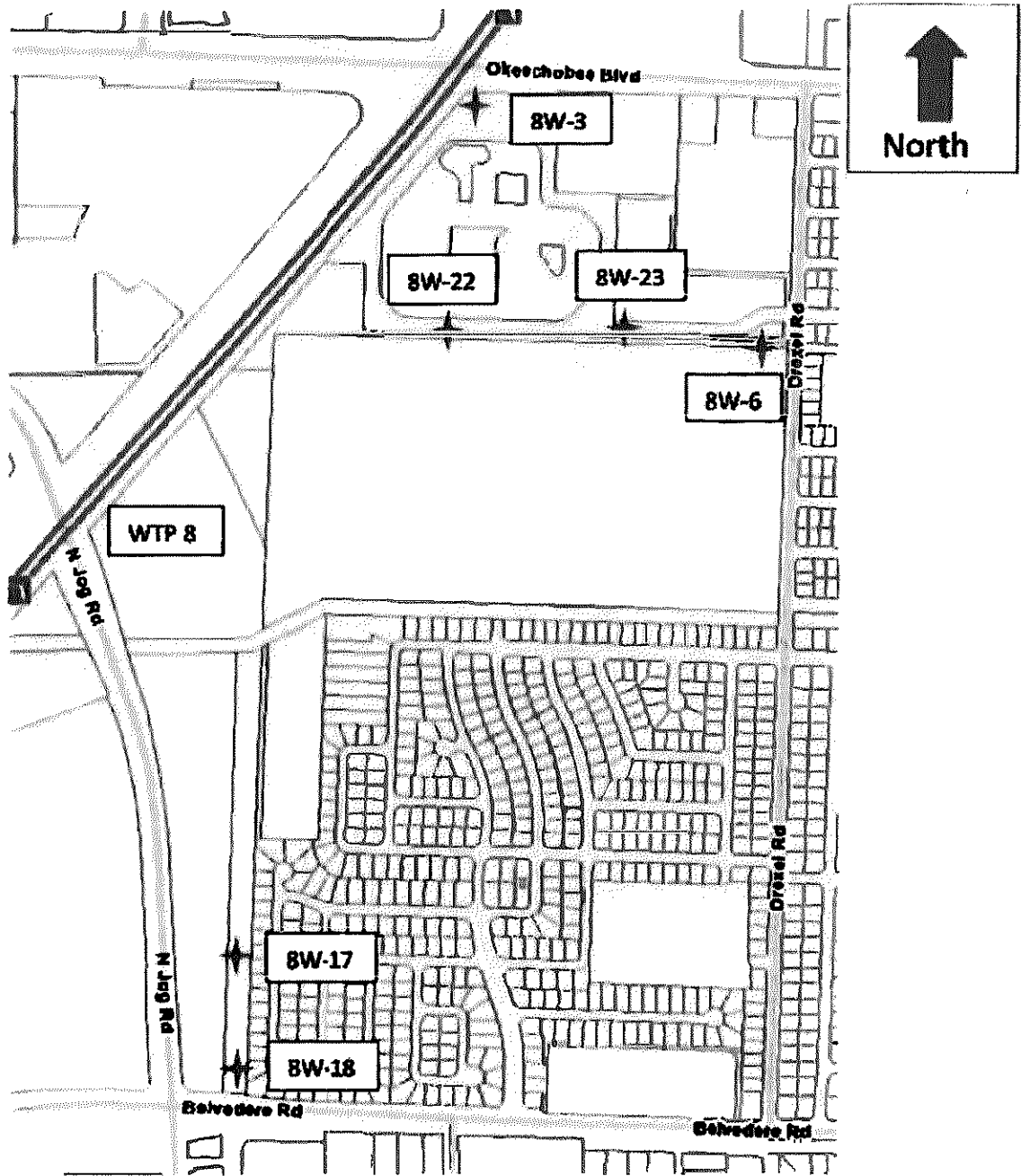

✦ Well Locations

Not to Scale

WTP 8 – Water Treatment Plant No. 8

Revised 04/26/2021



**Palm Beach County
Compliance Summary Report**

Vendor Number	Vendor Name	AM Best Rating	Insurance Carrier	Policy #	Eff. Date	Exp. Date	Coverage	Contract Number	Contract Name
DX00000331	JLA Geosciences Inc	Modified	Compliant					18-051	Consulting/Professional Services system-Wide Wellfield Improvements Hydrogeologic, Engineering Design and Construction Services
		Ar , XV	Midvale Indemnity Company	CA00024841	4/22/2024	4/22/2025	Auto Liability		
		Ar , XV	Crum & Forster Specialty Insurance Company	EFX125151	4/22/2024	4/22/2025	Excess Liability		
		Ar , XV	Crum & Forster Specialty Insurance Company	EPK147570	4/22/2024	4/22/2025	General Liability		
		Ar , XV	Crum & Forster Specialty Insurance Company	EPK147570	4/22/2024	4/22/2025	Professional Liability		
		A-r , XV	Associated Industries Insurance Company, Inc.	AWC1206349	5/8/2024	5/8/2025	Workers Comp		

Risk Profile : Contract Review Requirements

Required Additional Insured : Palm Beach County Board of County Commissioners

Ownership Entity :