

PALM BEACH PARK

BEING A SUBDIVISION OF THE N 1/4 OF SEC 26 T 43 S R 37 E

PALM BEACH COUNTY, FLA.

BRIDGEMAN AND ALLEN, INC.
ENGINEERS
307 GARDENIA ST.
WEST PALM BEACH, FLA.

MARCH 1926

SCALE 1"=100 FT.

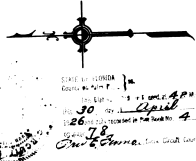
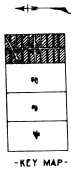

This is not a certified copy

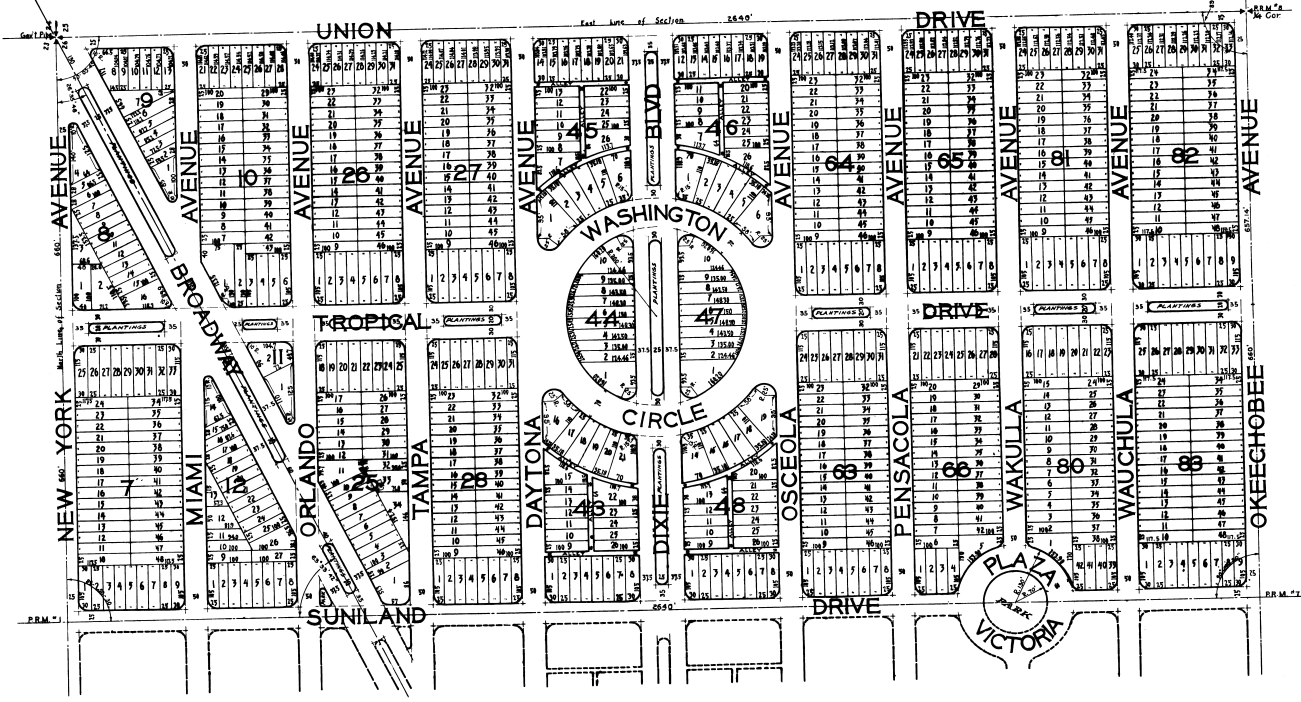

Note: Dimensions in corners refer to the subdivision of actual lines referred except where otherwise shown in plan. All notes are to be read in connection with the plan.

Approved by Board of County Commissioners
By *[Signature]*
County Engineer